

BENNING PARK COMMUNITY CENTER COMMUNITY MEETING



MONDAY, SEPTEMBER 23, 2019



BUILD ^{*}**
MAINTAIN
SUSTAIN



Rules of the Road:

Welcome! Thank you for your participation.

- Please Hold all questions until the end of the presentation.

AGENDA:

- Project Overview: Budget and Timeline
- Project Scope of Work:
- Design: remodeled floor plans
- DPR Programs
- DOEE: special storm-water update
- USSF: court update
- Next Steps
- Q&A



Project Overview



Existing Site Layout

Project Budget and Timeline:

- FY16 - \$5m + FY20 - \$5m = Total Project: \$10 million + \$1.25m allowance = \$11,250,000 Budget
- June 2019: The Phase 2 contract was finalized with the architect
- July 2019: The Phase 1 and Phase 2 Design Drawings were completed, the Permit & Bid Set
- August 2019: The Permit set was submitted to DCRA
- September 2019: An RFP for a General Contractor was released
- September 2019: Pre-proposal conference
- Winter 2019-2020: General Contractor will be on board to be introduced to the community
- Spring 2020: Construction tentative to begin

BENNING PARK CONSTRUCTION PROCESS

- NOW FULLY FUNDED -

PHASE 1:

- Roof Replacement
- New Bathrooms
- New HVAC Equipment
- Elevator Added
- ADA Improvements
- Life Safety Improvements
- Boxing Ring

PHASE 2:

- Building Renovation
- Pool Lockers
- New A/V and Security Systems
- Landscape Improvements
- New Windows and Doors
- Renovated Parking Lot
- Storm Water Management

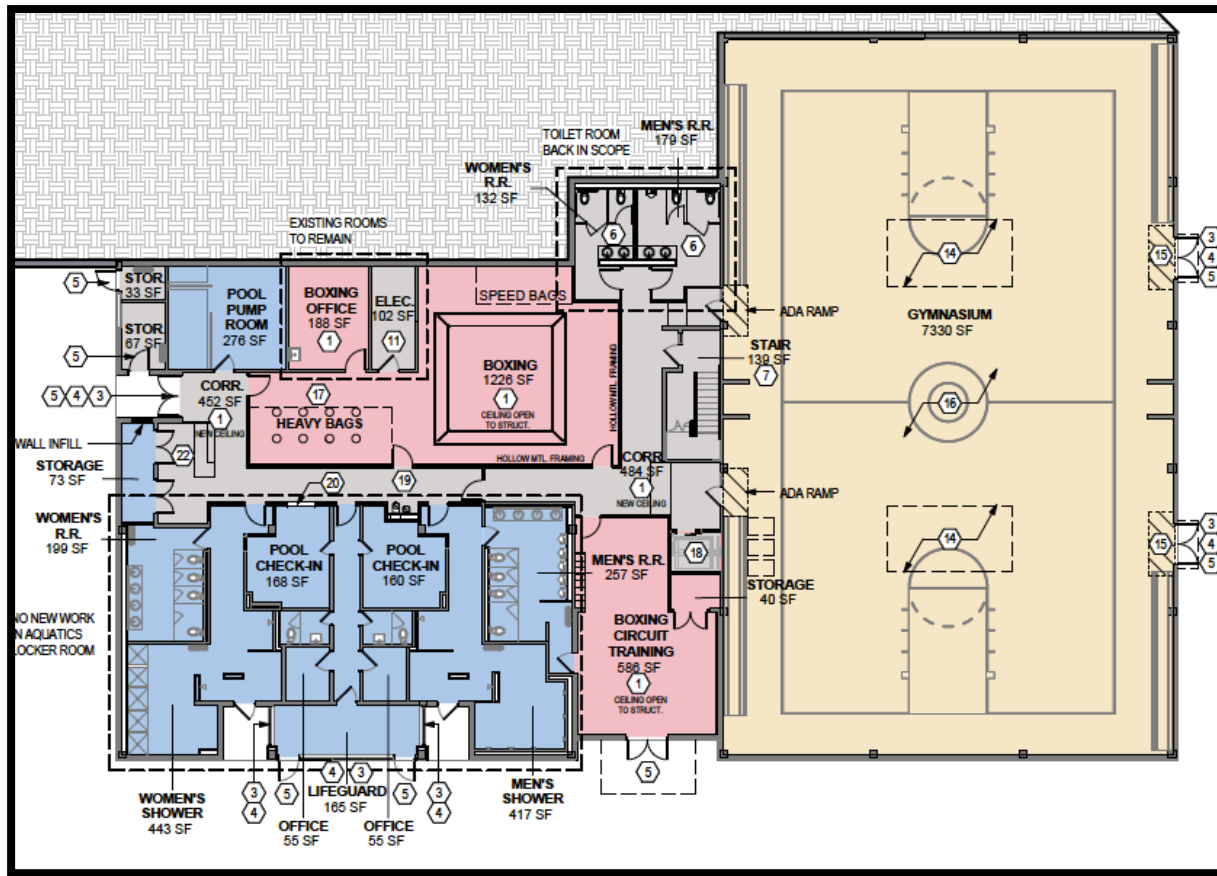

Legend

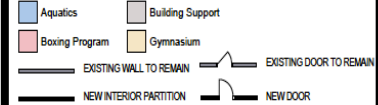

Key Notes

- 1 PROVIDE NEW WALL PAINT & FLOOR FINISHES.
- 2 PROVIDE NEW WALL PAINT FINISH. TYPICAL THROUGHOUT
- 3 REPLACE EXISTING HOLLOW METAL WINDOW WITH NEW WINDOW.
- 4 PROVIDE WINDOW WITH SECURITY GRILL. (MAINTAIN DEDUCT ALTERNATE FOR SECURITY FILM)
- 5 REPLACE EXTERIOR DOOR & PROVIDE SECURITY GRADE HARDWARE.
- 6 NEW COMPLAINT TOILET ROOM AND RESTROOM ACCESSORIES.
- 7 PROVIDE NEW PAINTED HANDRAIL / GUARDRAIL AT EXISTING STAIRWELL TO MEET LOCAL CODE REQUIREMENTS.
- 8 PROVIDE PAINTED METAL HANDRAIL AT EXISTING STAGE STAIRS.
- 9 PROVIDE NEW KITCHEN EQUIPMENT, PLUMBING FIXTURES, AND CABINETRY.
- 10 UPGRADES TO EXISTING TELECOMMUNICATIONS. (ADD ALTERNATE: NOT PART OF BASE SCOPE)
- 11 UPGRADE / MODIFICATIONS TO EXISTING ELECTRICAL & MECHANICAL SYSTEMS.
- 12 PROVIDE NEW CODE COMPLAINT FLOOR TRANSITION.
- 13 EXISTING FITNESS EQUIPMENT
- 14 ALL EXISTING CLERESTORY WINDOWS ARE TO REMAIN. PRESERVE AND PROTECT.
- 15 ADD ALTERNATE: REPLACE EXISTING CLERESTORY HOLLOW METAL WINDOWS
- 16 REPAIR DAMAGED WOOD FLOOR IN AREA SHOWN.
- 17 REPLACE ALL EXISTING HIGH BAY LIGHTING WITH L.E.D. LIGHT FIXTURES.
- 18 PROVIDE ADEQUATE SUPPORT FOR HEAVY BAG BOXING EQUIPMENT.
- 19 PROVIDE NEW ELEVATOR.
- 20 PROVIDE CODE COMPLAINT DUAL ELECTRIC WATER COOLER
- 21 PROVIDE NEW OVER HEAD COLLING COUNTER DOOR
- 22 PROVIDE NEW / UPGRADE AUDIO / VISUAL TECHNOLOGY (ADD ALTERNATE: NOT PART OF BASE SCOPE)
- 23 PROVIDE NEW FRONT DESK / FINISHED CASWORK (ADD ALTERNATE: NOT PART OF BASE SCOPE)

Ground Floor

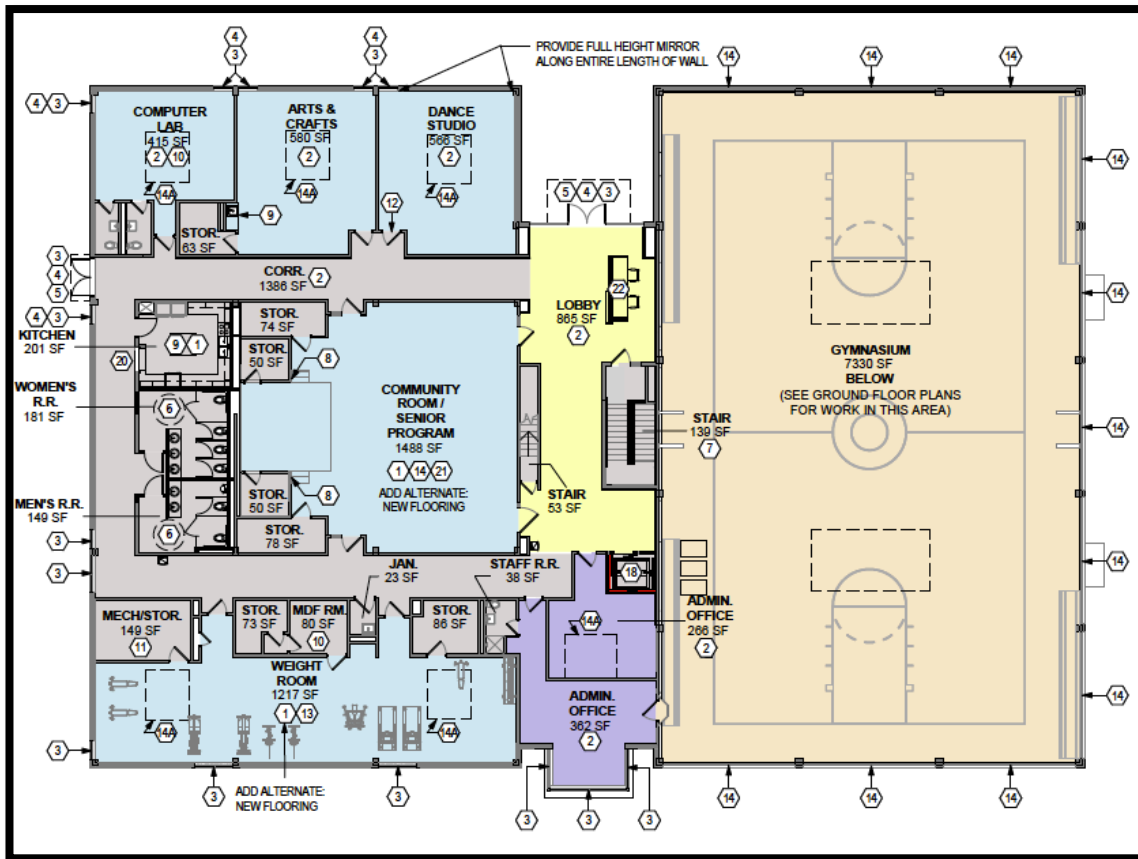

First Floor

Legend

Key Notes

- PROVIDE NEW WALL PAINT & FLOOR FINISHES.
- PROVIDE NEW WALL PAINT FINISH, TYPICAL THROUGHOUT
- REPLACE EXISTING HOLLOW METAL WINDOW WITH NEW WINDOW.
- PROVIDE WINDOW WITH SECURITY GRILL. (MAINTAIN DEDUCT ALTERNATE FOR SECURITY FILM)
- REPLACE EXTERIOR DOOR & PROVIDE SECURITY GRADE HARDWARE.
- NEW COMPLIANT TOILET ROOM AND RESTROOM ACCESSORIES.
- PROVIDE NEW PAINTED HANDRAIL / GUARDRAIL AT EXISTING STAIRWELL TO MEET LOCAL CODE REQUIREMENTS.
- PROVIDE PAINTED METAL HANDRAIL AT EXISTING STAGE STAIRS.
- PROVIDE NEW KITCHEN EQUIPMENT, PLUMBING FIXTURES, AND CABINETRY.
- UPGRADES TO EXISTING TELECOMMUNICATIONS. (ADD ALTERNATE: NOT PART OF BASE SCOPE)
- UPGRADE / MODIFICATIONS TO EXISTING ELECTRICAL & MECHANICAL SYSTEMS.
- PROVIDE NEW CODE COMPLIANT FLOOR TRANSITION.
- EXISTING FITNESS EQUIPMENT
- ALL EXISTING CLERESTORY WINDOWS ARE TO REMAIN. PRESERVE AND PROTECT.
- ADD ALTERNATE: REPLACE EXISTING CLERESTORY HOLLOW METAL WINDOWS
- REPAIR DAMAGED WOOD FLOOR IN AREA SHOWN.
- REPLACE ALL EXISTING HIGH BAY LIGHTING WITH L.E.D. LIGHT FIXTURES.
- PROVIDE ADEQUATE SUPPORT FOR HEAVY BAG BOXING EQUIPMENT.
- PROVIDE NEW ELEVATOR.
- PROVIDE CODE COMPLIANT DUAL ELECTRIC WATER COOLER
- PROVIDE NEW OVER HEAD COILING COUNTER DOOR
- PROVIDE NEW / UPGRADE AUDIO / VISUAL TECHNOLOGY

DPR Programming Update:

NOTE: Benning Park to remain open until construction begins in spring 2020!

Special Events:

Family Game Nights
Movie Night
Fun Wagon: Bikes and Skates
Dance Night

Programs:

Football



DPR Partnership Update: DOEE Stormwater Work

(Separate Funding Source)

Capture Water and Reduce Runoff:

Website:

<https://doee.dc.gov/node/1321671>



DPR Donation Update: USSF/Target Mini-Pitch/Soccer Court

Renovate the under-utilized tennis court with a new soccer court.

Court Now Open!

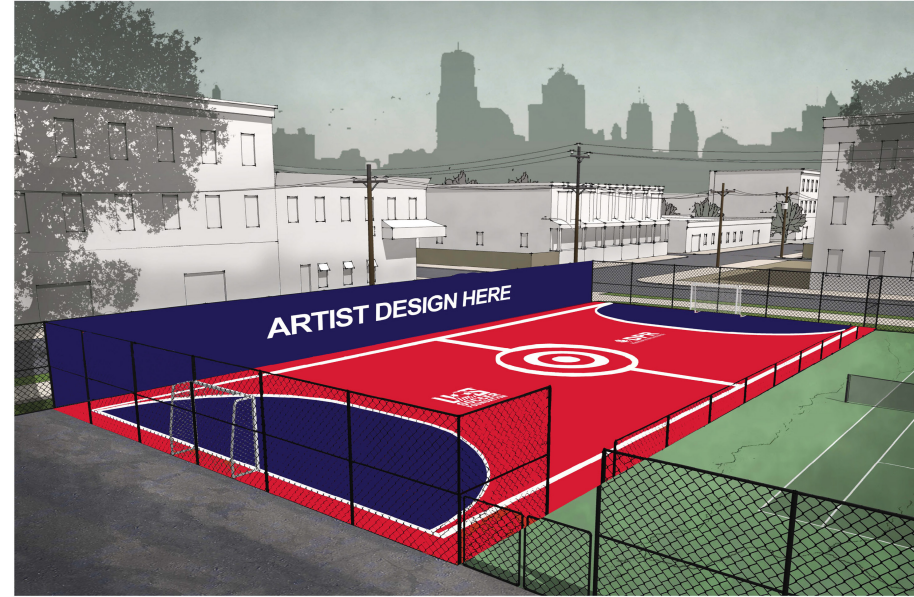

Next Steps:

- **Presentation Available at:**
- <https://dgs.dc.gov/node/1110284>
- **Contractor Hired**
- **Community Meeting introducing the contractor**
- **Updated Timelines**



Contact Information

Department of General Services (DGS)

Wayne Gore, Community Outreach Specialist

Wayne.Gore@dc.gov

Department of Parks & Recreation (DPR)

Peter Nohrden, ASLA / Project Manager

Peter.Nohrden@dc.gov

