

**NARRATIVE**

 **MOVEDC**

- 
- VISION ZERO**

- ### LEGEND

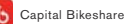

■ Primary Pedestrian Circulation

### Secondary Pedestrian Circulation

■ Tertiary Pedestrian Circulation

■ **Bicycle/Tricycle Track**

High Volume Foot-traffic Area

■ Primary Vehicular Circulation

Secondary Vehicular Circulation

|||| Crosswalk

PN 2018043 | 12.03.2018 | DEPARTMENT OF GENERAL SERVICES + DEPARTMENT OF PARKS AND RECREATION



# REFINED MASTER PLAN ALTERNATE Safety

## NARRATIVE

One key District initiative regarding transportation, Vision Zero, together with the traffic analysis in the Original 2015 Master Plan, initial discussions with DDOT and guidance from Crime Prevention Through Environmental Design (CPTED) principles provided the initial guidance for design decisions at the master plan level. This information has resulted in several design moves that will provide safer conditions throughout the park and surrounding streets. First, the closure of both D Street SE "bow tie" sections expands the park area improving pedestrian connectivity and reducing risk in vehicular traffic circulation. Second, the realignment of the South Carolina Avenue SE intersections with 7th Street SE and 9th Street SE narrows the intersection reducing vehicular speed and creating a shorter crossing for pedestrians, making the intersection safer for both. Fourth, bulb-outs at key intersections provide traffic calming and improve pedestrian safety. Finally, moving the location of the playground North towards D-Street allows for safer play away from the busy Pennsylvania Avenue.

## VISION ZERO

- Improved Intersection Alignments reduce traffic accidents
- Traffic Calming measures reduce speeds and protect pedestrians
- New Pedestrian Space improves connectivity and opportunities or social interactions



## LEGEND

- Narrowed Intersection
- Pedestrian Light Fixtures - Low
- Pedestrian Light Fixtures - Moderate
- Ex. Street Lights
- Clear Wayfinding Point
- Low Planting Areas
- Clear Sight Lines and Areas
- Street Closure

NOTE: EXHIBIT TO BE UPDATED AFTER EXISTING CONDITIONS SURVEY + INITIAL AGENCY MEETINGS ARE COMPLETED.





## REFINED MASTER PLAN ALTERNATE Urban Planning + Design

### NARRATIVE

Two key District documents regarding urban planning and design, the Comprehensive Plan and the Public Realm Design Manual provided the initial guidance for design decisions at the master plan level. Though light on details, the Comprehensive Plan clearly states that this park is envisioned as the new "Town Center" for the Capitol Hill neighborhood.

The Refined Master Plan embraces this directive by creating a central gathering space adjacent the Southeast Neighborhood Library, a critical civic presence and resource. Together these provide a core space for strengthening civic engagement and community identity.

Throughout the park and streetscape, dimensions and materials will be informed by the Public Realm Design Manual. Select areas may vary from the standards for specific reasons of wayfinding, defining civic spaces, or highlighting cultural or art features.

### COMPREHENSIVE PLAN

- Town Center of Capitol Hill provides civic space for community events and identity
- Public Art supports community identity and town center core
- Visual Corridors maintained street axes of South Carolina + D Street

### PUBLIC REALM DESIGN MANUAL

- Standard Pavers maintained on outside edges
- Standard Metal Fence to enclose playground
- Standard Curb + Gutter for new street alignments

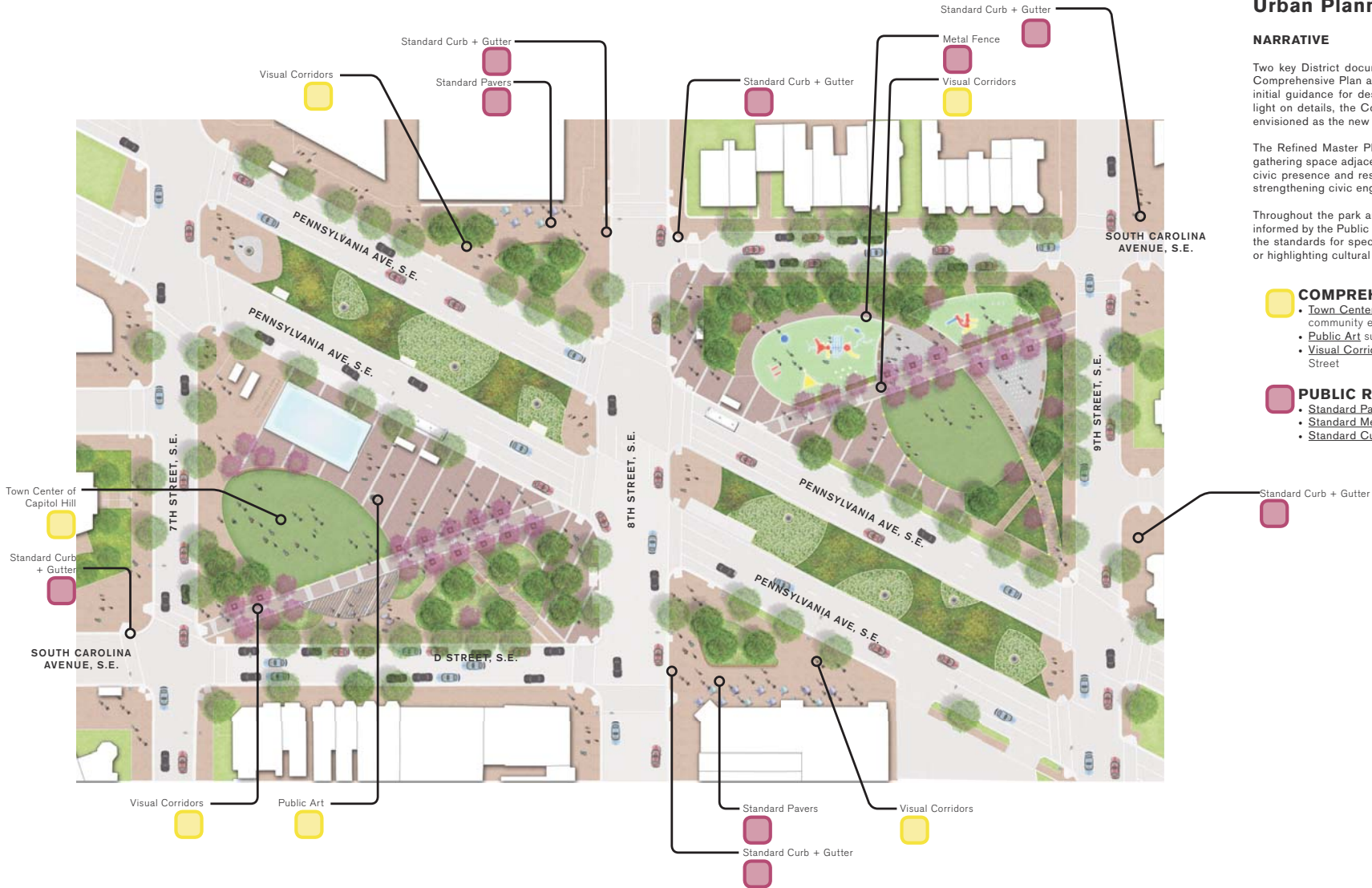

## EASTERN MARKET METRO PARK WASHINGTON, D.C. • MASTER PLAN: OPTION 4

PN 2018043 | 12.03.2018 | DEPARTMENT OF GENERAL SERVICES + DEPARTMENT OF PARKS AND RECREATION

NOTE:  
EXHIBIT TO BE UPDATED AFTER EXISTING CONDITIONS SURVEY + INITIAL AGENCY MEETINGS ARE COMPLETED.



# MEDIAN OPTIONS



**Option A:  
Landscape**

Native pollinator garden

Native pollinator landscape



**Option B:  
Art + Light**

Sculpture with  
accent paving

Ribbon light around  
plant bed

Sculpture

Sculpture

Monoculture plant bed

Mixed meadow plant bed



**Option C:  
Light**

Bermed plant bed

Ribbon light around  
mound

Mixed meadow plant bed

