

Lansburgh Park

Community Meeting

August 10, 2020



Welcome! Thank you for your participation.

- Please keep your microphone on mute.
- Please use the chat feature to ask questions or provide comments which will be read during the “Question Breaks”.
- The chat function is located beside your name in the Participant Panel – looks like a cloud symbol. Be sure to submit your question / comment to “Everyone” so the design team can see them.
- We’ll do the best we can to answer all questions, but if your question is not answered, DPR is tracking all questions and will create a Q/A document that will be shared after the meeting.

CHAT ICON



READY2PLAY

District of
Columbia

Parks and Recreation Master
Plan

#Ready2PlayDC
#DPRisListenin

Ready2playdc.com



GOVERNMENT OF THE
DISTRICT OF COLUMBIA
MURIEL BOWSER, MAYOR



BUILD 
MAINTAIN
SUSTAIN



★ ★ ★
WE ARE
WASHINGTON
DC

AGENDA

1. Introductions
2. Project Overview
3. Project Site and Site Analysis
4. Project Stabilization and Design
5. Next Steps
6. Contact Information
7. Questions:

SCOPE OF WORK

- Budget: \$900,000
- Revitalize the historic stage, pavilions and seating plaza
- Install new lighting
- Add an ADA ramp to the stage
- Repair concrete, cobblestone and other ADA trip hazards
- Add a bottle filler and drinking fountain
- Site furnishings (benches, etc.)
- Add a play area
- New site signage and murals



Aerial Map



Aerial Map

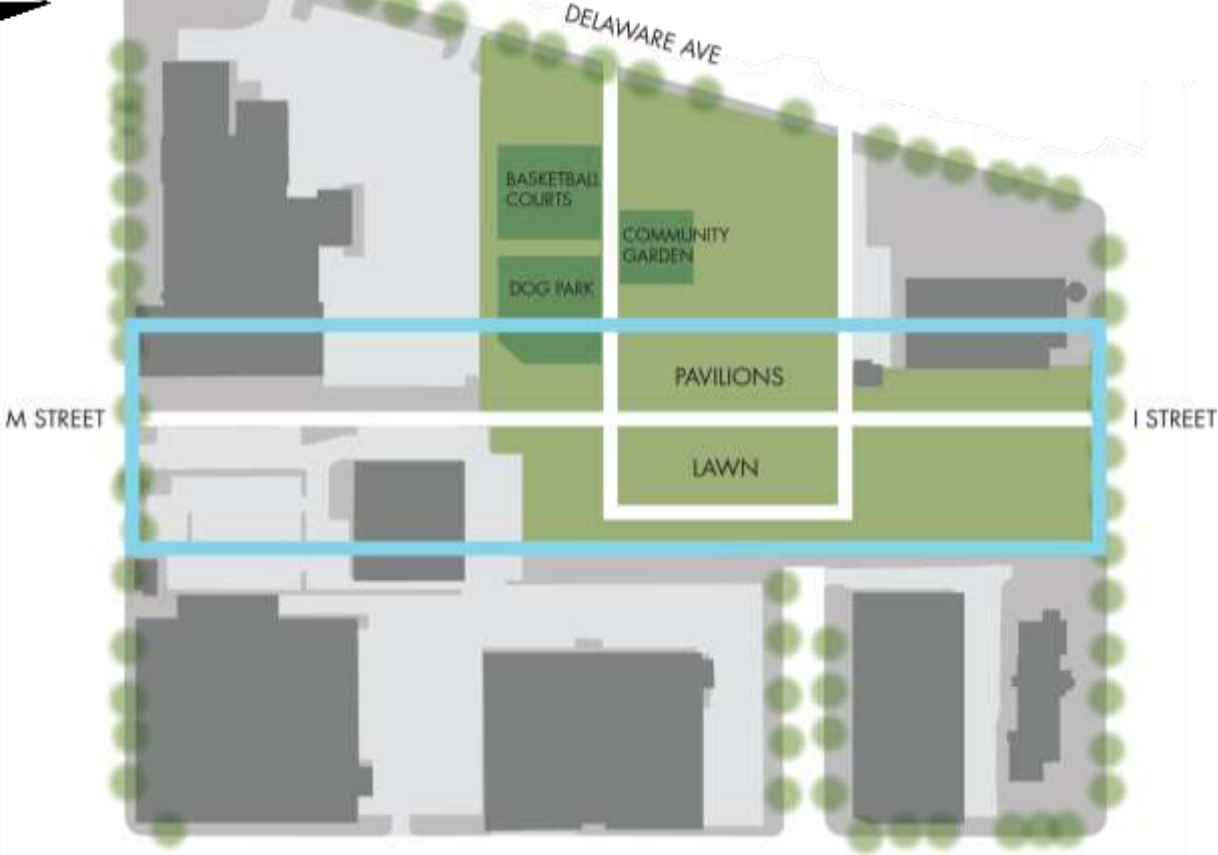

Existing Conditions



VAULTED METAL-CLAD ARBORS Existing Conditions

Existing Conditions

- Metal structures have deteriorated over the years with corrosion from rain and debris collection
- Metal posts have been cut and not properly sealed
- Vaulted canopies are worn, rusted and broken
- Footings are corroded
- Existing lighting added over time is not in working condition



VAULTED METAL-CLAD ARBORS Proposed Repairs & Improvements

Proposed Repairs & Improvements

- Repair and refinish corroded metal structures
- Improve water drainage, debris collection and lower maintenance over time with minor alterations to the metal post tops
- Restore corroded posts and replace damaged roof surfaces. Improvements to retain the character of the original design
- New lighting is added to the underside of the vaulted structures to welcome arbor use, provide park lighting and to highlight the beautiful historic vault architecture



GRANITE IMBEDDED BLOCKS Existing Site Plan

Existing Conditions

- Granite blocks in grid pattern are generally in good condition but not ADA accessible. Some are raised by tree roots and broken.
- Protect all heritage trees. One heritage tree has been identified by the city arborist to be in poor condition and will be removed.



GRANITE IMBEDDED BLOCKS Proposed Site Plan

Proposed Repairs & Improvements

- Granite blocks will remain in their general grid pattern. Broken and raised paving will be replaced and leveled.
- To achieve ADA accessibility some granite paving will be removed to create larger leveled gathering areas. The original grid pattern will be represented through the control joints in the concrete. The removed paving will be reused to widen the walkway on opposite side of the path.
- To improve stormwater management pervious planted areas will be integrated, within the original grid pattern, to reduce rainwater runoff over the impervious area.
- Heritage trees will be protected. An accessible ramp will be added to access the bandstand in the location of the one removed tree.

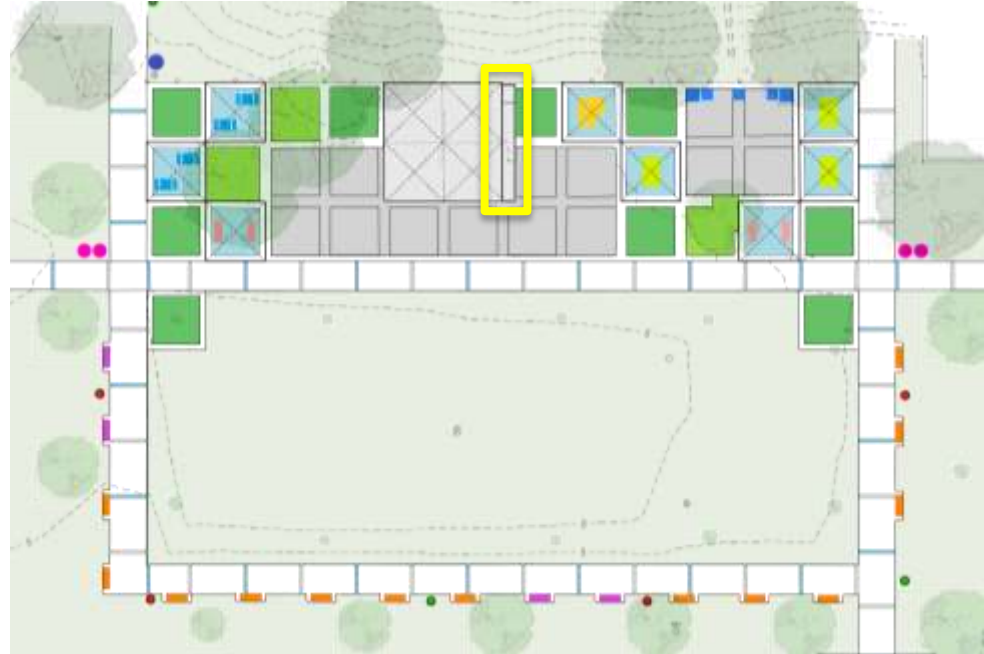

GRANITE IMBEDDED BLOCKS ADA Accessible Ramp & Paving



COLORED
CONCRETE PAVING



CONCRETE JOINTS



STAGE SURFACING

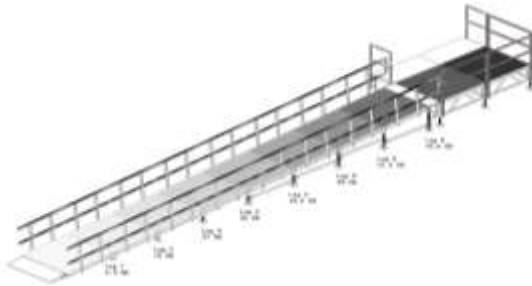

M STREET ENTRANCE

I STREET ENTRANCE

PROPOSED SITE PLAN



- EXISTING TREE PITS
- REPAIRED PAVILIONS WITH NEW LIGHTING
- PROPOSED BLUE COLORED CONCRETE PAVING
- PROPOSED GREY COLORED CONCRETE PAVING
- PROPOSED GREY COLORED EPOXY SURFACING
- PROPOSED LANDSCAPE PLANT BEDS
- PROPOSED COLORED PAVING ON WALKWAYS
- EXISTING BENCHES
- EXISTING BENCHES RELOCATED
- PROPOSED BENCHES BACKLESS
- PROPOSED BENCHES WITH BACKS
- EXISTING PICNIC TABLES
- PROPOSED ACCESSIBLE PICNIC TABLE
- PROPOSED DRINKING FOUNTAIN
- PROPOSED TRASH & RECYCLING BINS
- PROPOSED GAME TABLES
- PROPOSED GRILL AND COAL BIN
- PROPOSED PLAY STRUCTURES
- PROPOSED MURAL ART WALL
- PROPOSED PLAY AREA
- PROPOSED PLAY STRUCTURES
- PARK SIGNAGE
- EXISTING BOLLARDS
- UPDATE EXISTING PARK LIGHTING
- EXISTING PARK LIGHTING TO BE RELOCATED
- PROPOSED PARK LIGHTING

SCALE 1:20

PARK AMENITIES Seating, Plant Beds, Grill, Water Fountain, Trash & Recycle Bins



EXISTING I STREET PARK ENTRANCE



PROPOSED I STREET PARK ENTRANCE



EXISTING PARK



PROPOSED PARK DESIGN



EXISTING PARK



PROPOSED PLAY AREA



Next Steps:

This presentation will be sent to all attendees and will be posted to the DGS Capital Construction page at: <https://dgs.dc.gov/page/lansburgh-park-improvements>

- Continue drawings for permit based on community feedback
- Project anticipated to start Fall of 2020 and be completed by Winter 2020/2021.

Contact Information

Department of General Services (DGS)

Wayne Gore, Community Engagement and Outreach
wayne.gore@dc.gov

Department of Parks & Recreation (DPR)

Peter Nohrden, ASLA / Project Manager
peter.nohrden@dc.gov

QUESTIONS: BREAK

- Please use the chat feature to ask questions or provide comments
- We will read the Questions and then Answer them