

DEPARTMENT OF GENERAL SERVICES



Brian J. Hanlon
Director



2000 14TH Street, NW
Washington, DC 20009

August 13, 2014

Dear Lafayette SIT Team –

Attached are the slides from the architects' presentation this past Monday August 4th. As always, we greatly appreciate your feedback and dialogue as we all work to make this modernization a successful effort for the students, staff, and community of Lafayette. For those who may be viewing these for the first time, we believe it is important to mention here some of the larger take-aways from the meeting to provide context when reviewing these slides:

1. The team is now focused on developing design concepts 1 and 2 into the next phase of design. We believe Concept 3 poses many challenges, namely the overall reduction of the ballfield space and losing the current feel of the lower park. The team will particularly look at further developing the space at the corner of Broad Branch and Northampton and seeing how classrooms can be grouped in a way that allows for more flexibility in grade assignments.
2. While all of the concepts depict underground parking for 40-45 vehicles (which is less than the zoning requirements of 60), this will have to be continually analyzed against upcoming conversations with zoning officials, the school need, and budget implications as underground parking adds a significant cost premium to modernization projects.
3. The swing plans depicted are initial thoughts after speaking with one modular classroom vendor. We are reaching out to others to see if double-decker trailers can be utilized to reduce the footprint of the swing space as we know preserving the ballfields as much as possible is a community goal. We are also just now reaching out to athletic tenting firms to get a true idea of what is possible for gym space – and understand placing it over the existing outdoor basketball courts may be the most preferred location.

These are just the larger points to keep in mind when reviewing the slides. As with any project, we are listening to all feedback made during meetings and over email with the SIT, as well as meetings with executives at both DCPS, DPR, and DGS, to incorporate as much as possible to create a successful project. Thank you again for all of your efforts to date, and we look forward to seeing you at the next SIT meeting on September 2nd.

Sincerely,

DC Department of General Services

LAFAYETTE
ELEMENTARY SCHOOL

A SCHOOL ON THE PARK



AGENDA –SIT MEETING #4

- | | | |
|---|-------------------|-------------------|
| • Introductions | 10 minutes | 6:00-6:10 |
| • July 12th SIT Meeting | 20 minutes | 6:10-6:30 |
| • Site Analysis | 30 minutes | 6:30-7:00 |
| • Concept Schemes | 60 minutes | 7:00-8:00 |
| • Exterior Precedents | 15 minutes | 8:00-8:15 |
| • Swing Space | 15 minutes | 8:15-8:30 |
| • Wrap-up | 10 minutes | 8:30- 9:00 |



AGENDA - SIT MEETING #4

- | | | |
|-------------------------|------------|------------|
| • Introductions | 10 minutes | 6:00-6:10 |
| • July 12th SIT Meeting | 20 minutes | 6:10-6:30 |
| • Site Analysis | 30 minutes | 6:30-7:00 |
| • Concept Schemes | 60 minutes | 7:00-8:00 |
| • Exterior Precedents | 15 minutes | 8:00-8:15 |
| • Swing Space | 15 minutes | 8:15-8:30 |
| • Wrap-up | 10 minutes | 8:30- 9:00 |



VISIONING SUMMARY

Lafayette Elementary School

8/4/2014

Guiding Principles - Summary

	Guiding Principles	Top 4 Site Design Focus Criteria	Top 4 Building Design Focus Criteria	Top 4 Educational Goals
1	The building should support interaction and collaboration in flexible, adaptable learning environments	Organized site connection to community	Provide complimentary architecture - one that respects the original building design without copying it	Inspire student, provide excitement about learning, life long learners and foster critical thinking
2	The building should provide holistic learning environments that foster leadership, fitness, nutrition and discovery	Preservation of understated charm	Provide good flow and good sight lines	Holistic, healthy learning environments for leadership, fitness, nutrition, and discovery
3	The building should be safe and secure while at the same time inspire creativity and excitement for learning	Improve vehicular and pedestrian and service delivery traffic	Light, bright and airy building	Create nurturing environment
4	The building should provide a sense of community for students within the school and each classroom pod	Maximize fitness and play areas	Provide spaces that are kid appropriate scales	Sense of community for students



AGENDA - SIT MEETING #4

- | | | |
|-------------------------------------|-------------------|------------------|
| • Introductions | 10 minutes | 6:00-6:10 |
| • July 12 th SIT Meeting | 20 minutes | 6:10-6:30 |
| • Site Analysis | 30 minutes | 6:30-7:00 |
| • Concept Schemes | 60 minutes | 7:00-8:00 |
| • Exterior Precedents | 15 minutes | 8:00-8:15 |
| • Swing Space | 15 minutes | 8:15-8:30 |
| • Wrap-up | 10 minutes | 8:30- 9:00 |





Site Analysis

LAFAYETTE ELEMENTARY SCHOOL
PROPERTY LINE

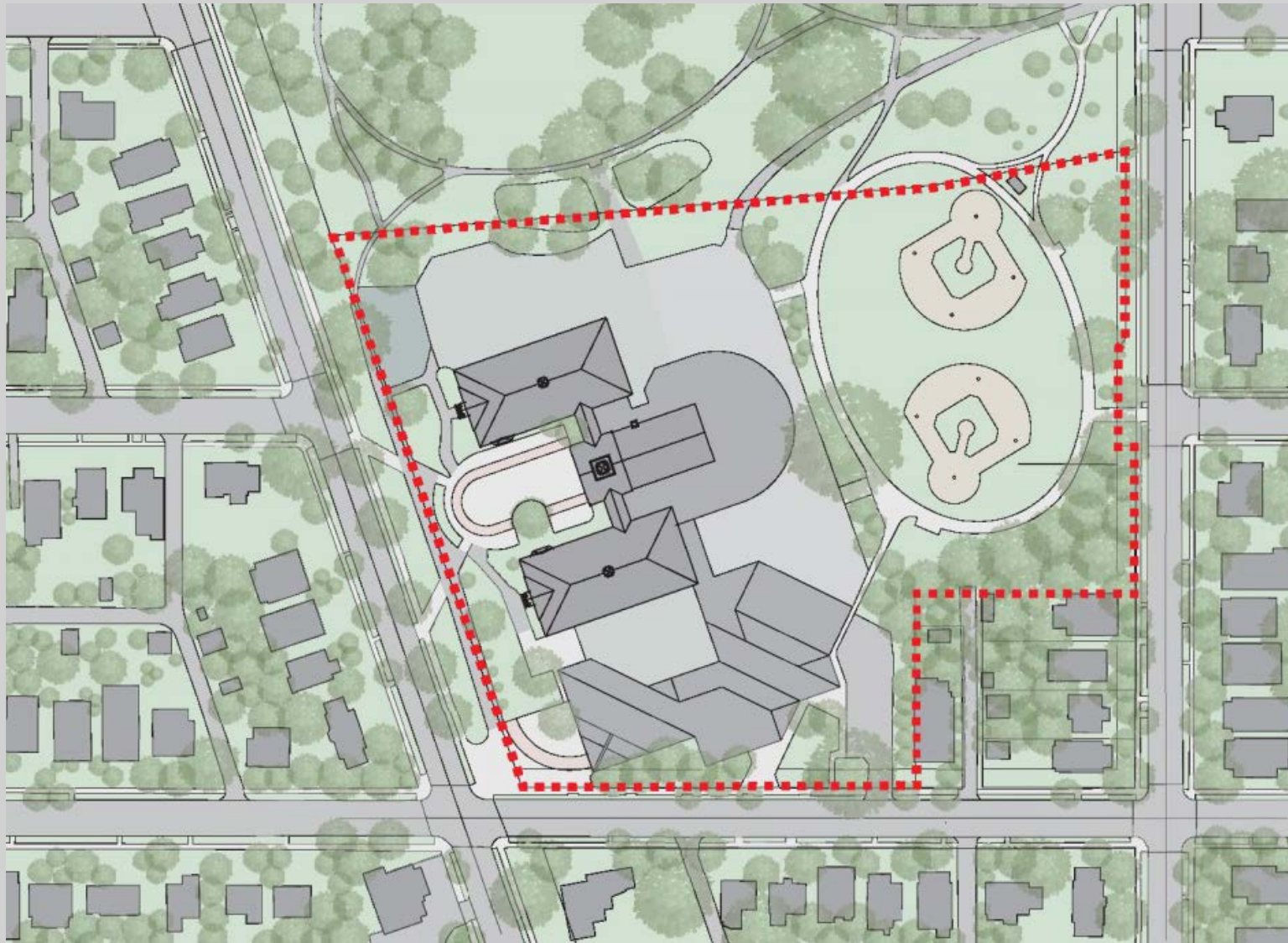

LAFAYETTE ELEMENTARY SCHOOL SIT MEETING – AUGUST 4, 2014



LAFAYETTE ELEMENTARY SCHOOL

HARTMAN-COX ARCHITECTS / GRIMM + PARKER ARCHITECTS
202.333.6446 / 301.595.1000

Site Analysis

LAFAYETTE ELEMENTARY SCHOOL
PROPERTY LINE AND EXISTING BUILDING TO REMAIN

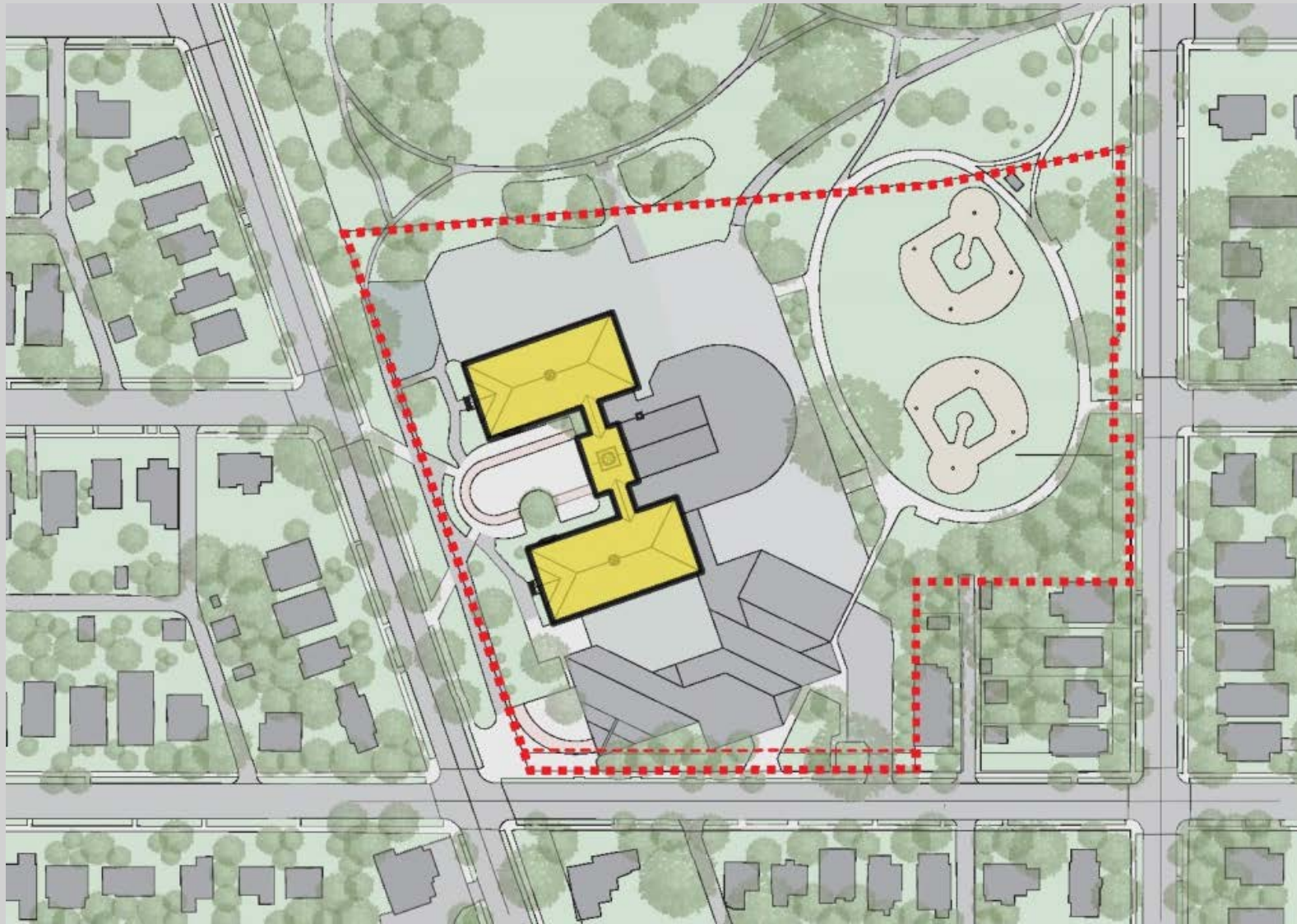

LAFAYETTE ELEMENTARY SCHOOL SIT MEETING – AUGUST 4, 2014



LAFAYETTE ELEMENTARY SCHOOL

HARTMAN-COX ARCHITECTS / GRIMM + PARKER ARCHITECTS
202.333.6446 / 301.595.1000

Site Analysis

LAFAYETTE ELEMENTARY SCHOOL BUILDING OFFSET AND SUBSTANTIAL SLOPE AREAS

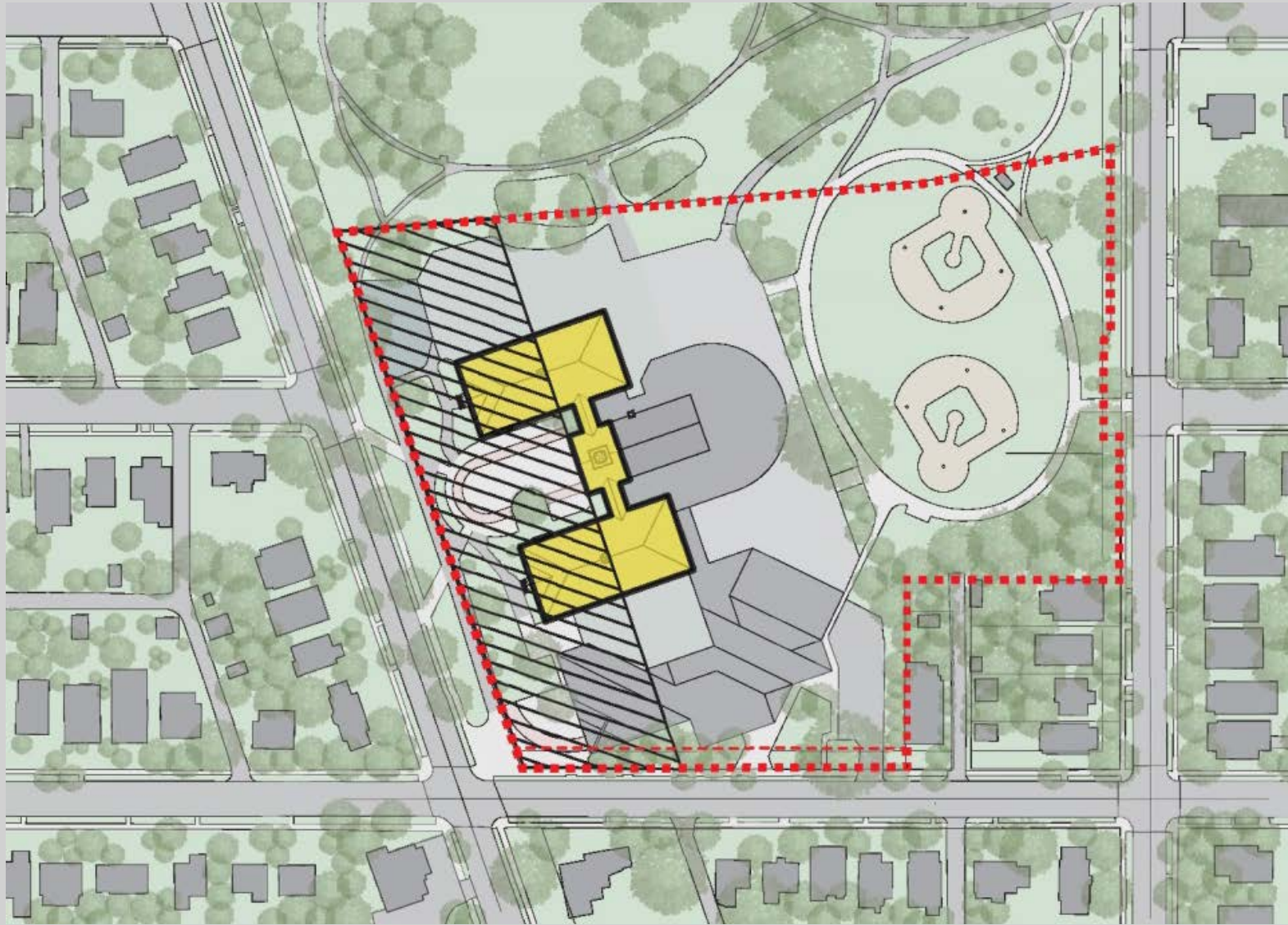

LAFAYETTE ELEMENTARY SCHOOL SIT MEETING – AUGUST 4, 2014



LAFAYETTE ELEMENTARY SCHOOL

HARTMAN-COX ARCHITECTS / GRIMM + PARKER ARCHITECTS
202.333.6446 / 301.595.1000

Site Analysis

LAFAYETTE ELEMENTARY SCHOOL
BUILDING ADDITION FOOTPRINT-2 FLOORS



LAFAYETTE ELEMENTARY SCHOOL SIT MEETING – AUGUST 4, 2014



LAFAYETTE ELEMENTARY SCHOOL

HARTMAN-COX ARCHITECTS / GRIMM + PARKER ARCHITECTS
202.333.6446 / 301.595.1000

Site Analysis

LAFAYETTE ELEMENTARY SCHOOL PARKING AND LOADING AREAS

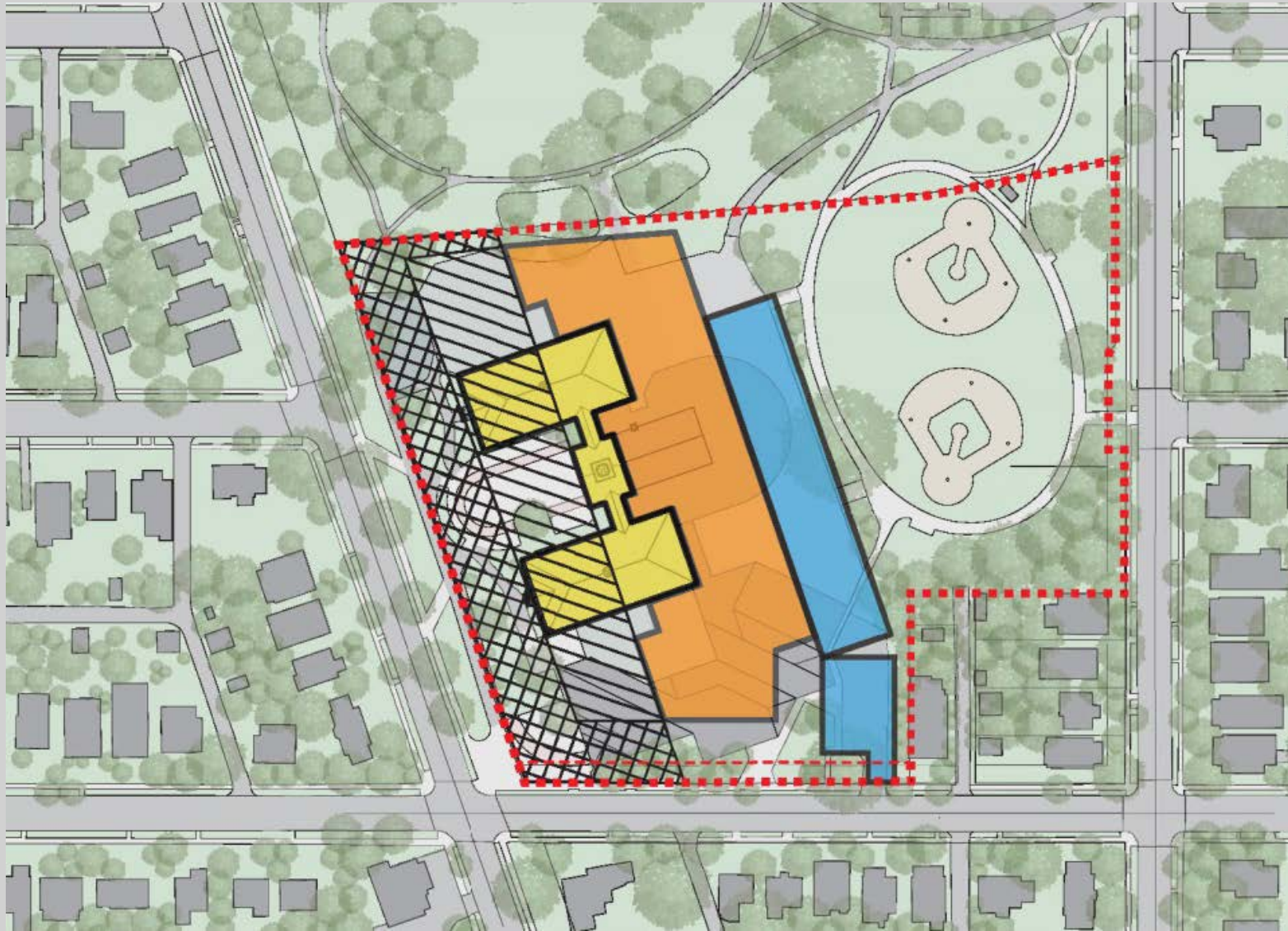

LAFAYETTE ELEMENTARY SCHOOL SIT MEETING – AUGUST 4, 2014



LAFAYETTE ELEMENTARY SCHOOL

HARTMAN-COX ARCHITECTS / GRIMM + PARKER ARCHITECTS
202.333.6446 / 301.595.1000

Site Analysis

LAFAYETTE ELEMENTARY SCHOOL RAIN GARDENS FOR STORM WATER MANAGEMENT



LAFAYETTE ELEMENTARY SCHOOL SIT MEETING – AUGUST 4, 2014



LAFAYETTE ELEMENTARY SCHOOL

HARTMAN-COX ARCHITECTS / GRIMM + PARKER ARCHITECTS
202.333.6446 / 301.595.1000

Site Analysis

LAFAYETTE ELEMENTARY SCHOOL PLAYGROUNDS – NEW VERSUS EXISTING



LAFAYETTE ELEMENTARY SCHOOL SIT MEETING – AUGUST 4, 2014



LAFAYETTE ELEMENTARY SCHOOL

HARTMAN-COX ARCHITECTS / GRIMM + PARKER ARCHITECTS
202.333.6446 / 301.595.1000

AGENDA - SIT MEETING #4

- | | | |
|-------------------------------------|-------------------|------------------|
| • Introductions | 10 minutes | 6:00-6:10 |
| • July 12 th SIT Meeting | 20 minutes | 6:10-6:30 |
| • Site Analysis | 30 minutes | 6:30-7:00 |
| • Concept Schemes | 90 minutes | 7:00-8:00 |
| • Exterior Precedents | 15 minutes | 8:00-8:15 |
| • Swing Space | 15 minutes | 8:15-8:30 |
| • Wrap-up | 10 minutes | 8:30- 9:00 |



Concept-Option 1

LAFAYETTE ELEMENTARY SCHOOL SITE PLAN

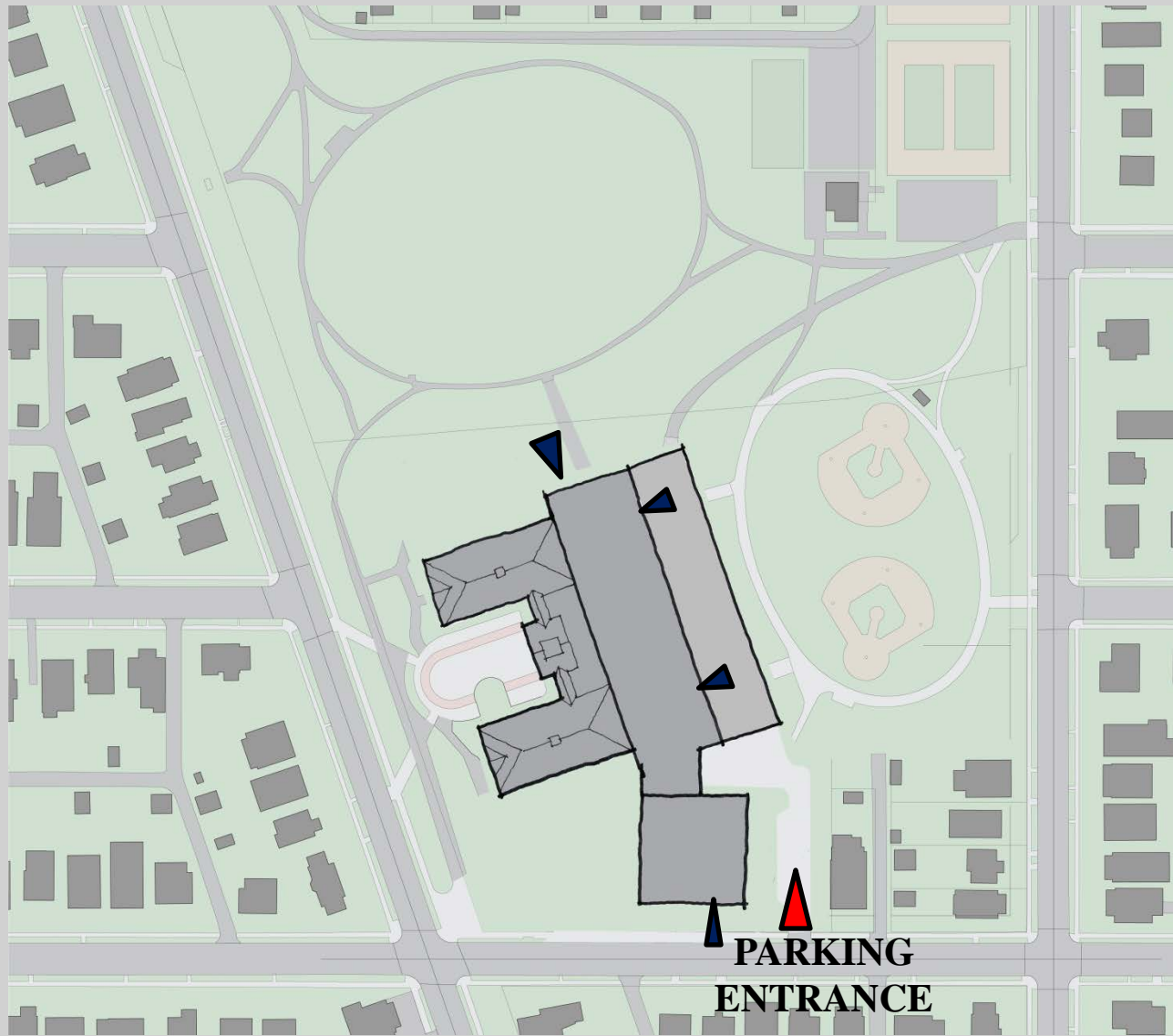

LAFAYETTE ELEMENTARY SCHOOL SIT MEETING – AUGUST 4, 2014



LAFAYETTE ELEMENTARY SCHOOL

HARTMAN-COX ARCHITECTS / GRIMM + PARKER ARCHITECTS
202.333.6446 / 301.595.1000

Option 1-Floor B

LAFAYETTE ELEMENTARY SCHOOL CONCEPT SCHEMES

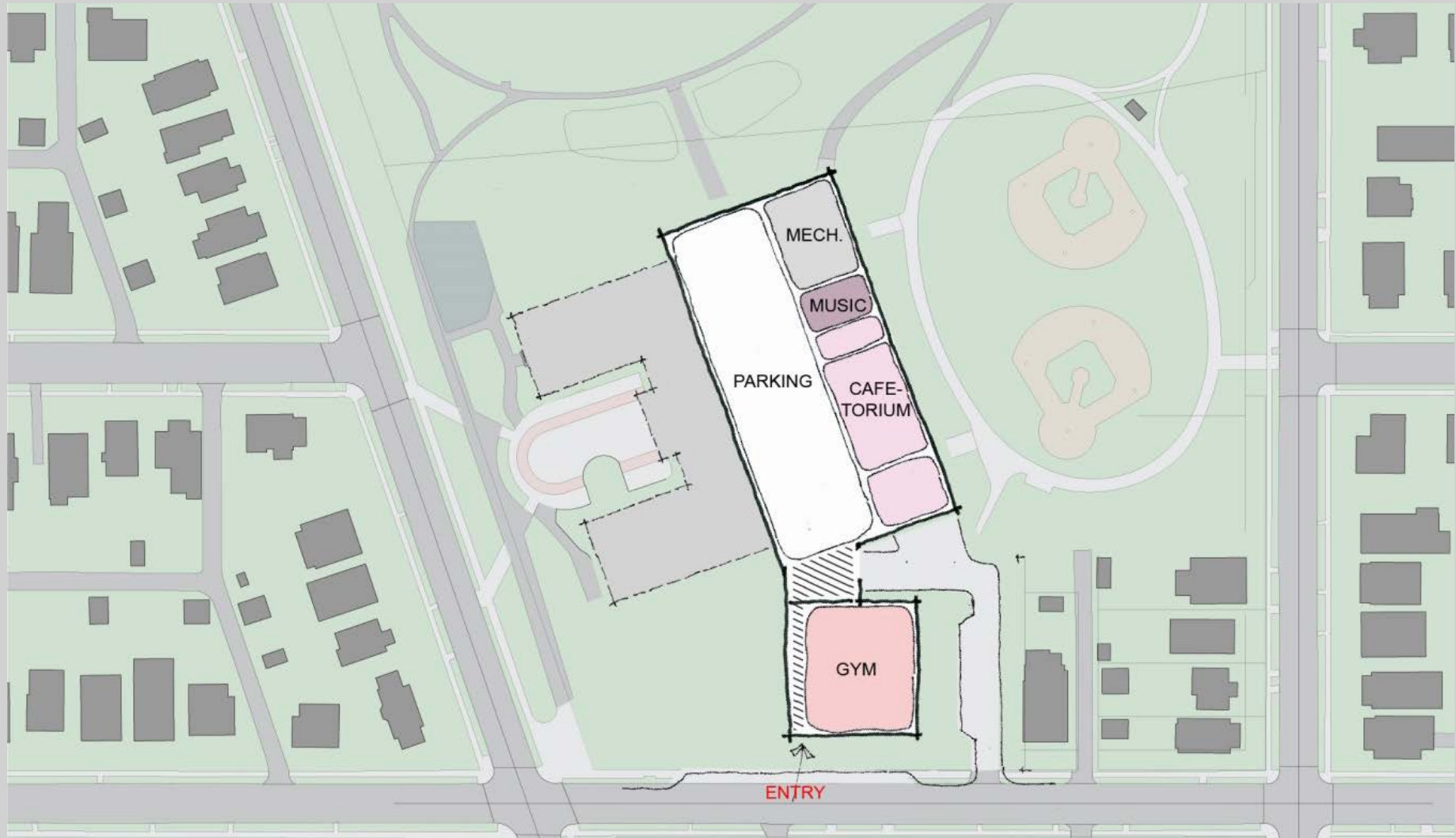

LAFAYETTE ELEMENTARY SCHOOL SIT MEETING – AUGUST 4, 2014



LAFAYETTE ELEMENTARY SCHOOL

HARTMAN-COX ARCHITECTS / GRIMM + PARKER ARCHITECTS
202.333.6446 / 301.595.1000

Option 1-Floor 1

LAFAYETTE ELEMENTARY SCHOOL CONCEPT SCHEMES

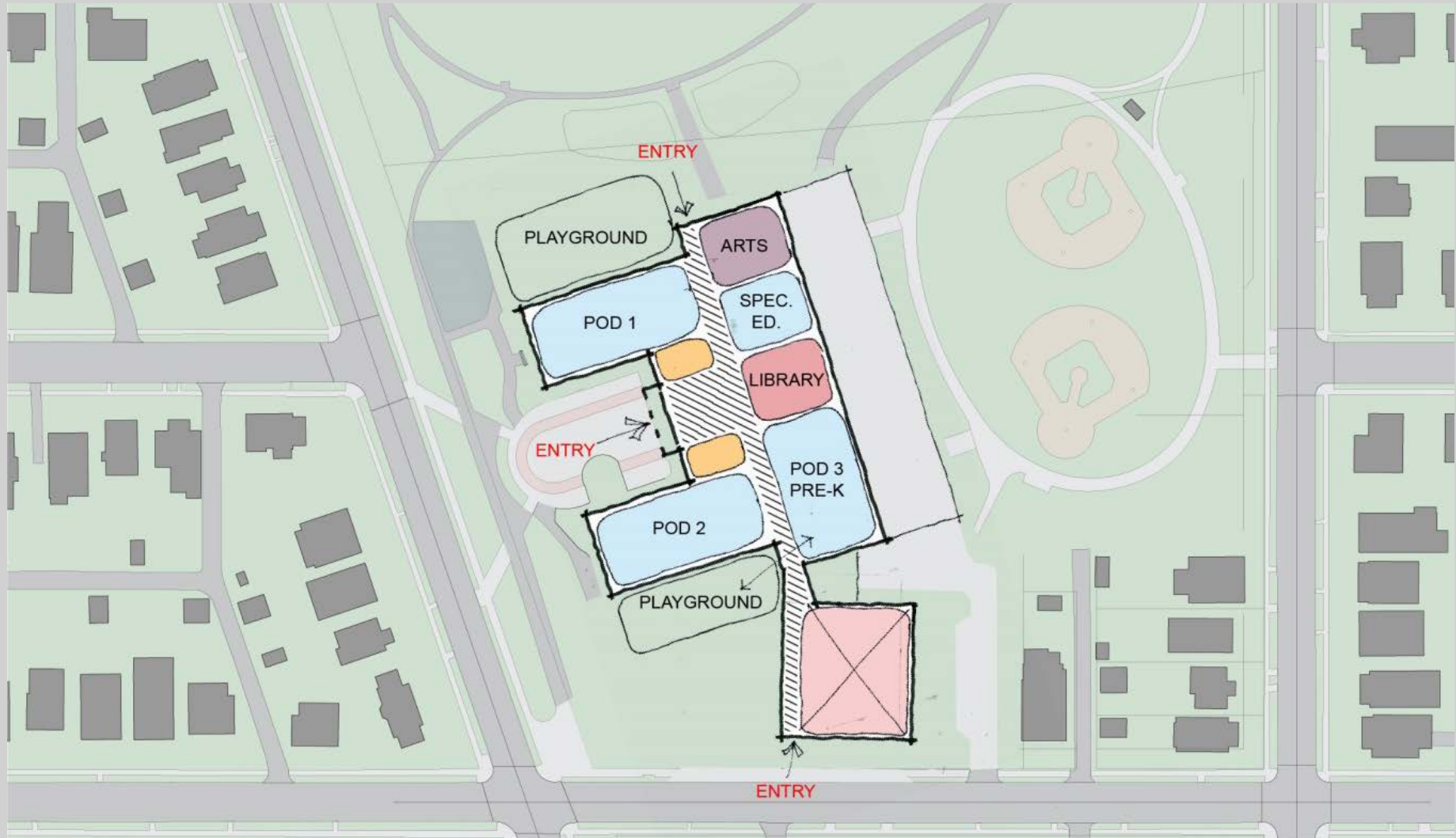

LAFAYETTE ELEMENTARY SCHOOL SIT MEETING – AUGUST 4, 2014



LAFAYETTE ELEMENTARY SCHOOL

HARTMAN-COX ARCHITECTS / GRIMM + PARKER ARCHITECTS
202.333.6446 / 301.595.1000

Option 1-Floor 2

LAFAYETTE ELEMENTARY SCHOOL CONCEPT SCHEMES

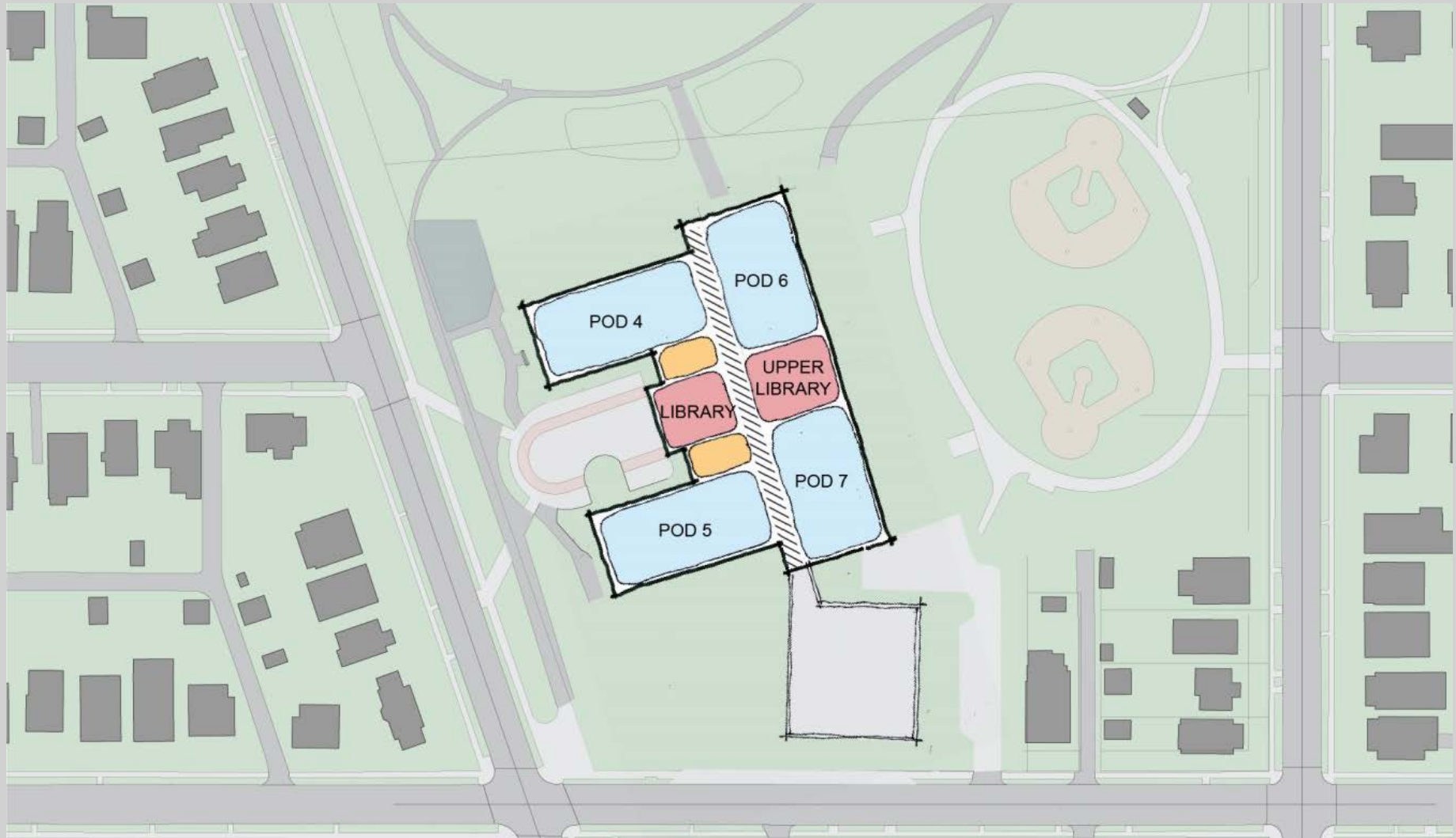

LAFAYETTE ELEMENTARY SCHOOL SIT MEETING – AUGUST 4, 2014



LAFAYETTE ELEMENTARY SCHOOL

HARTMAN-COX ARCHITECTS / GRIMM + PARKER ARCHITECTS
202.333.6446 / 301.595.1000

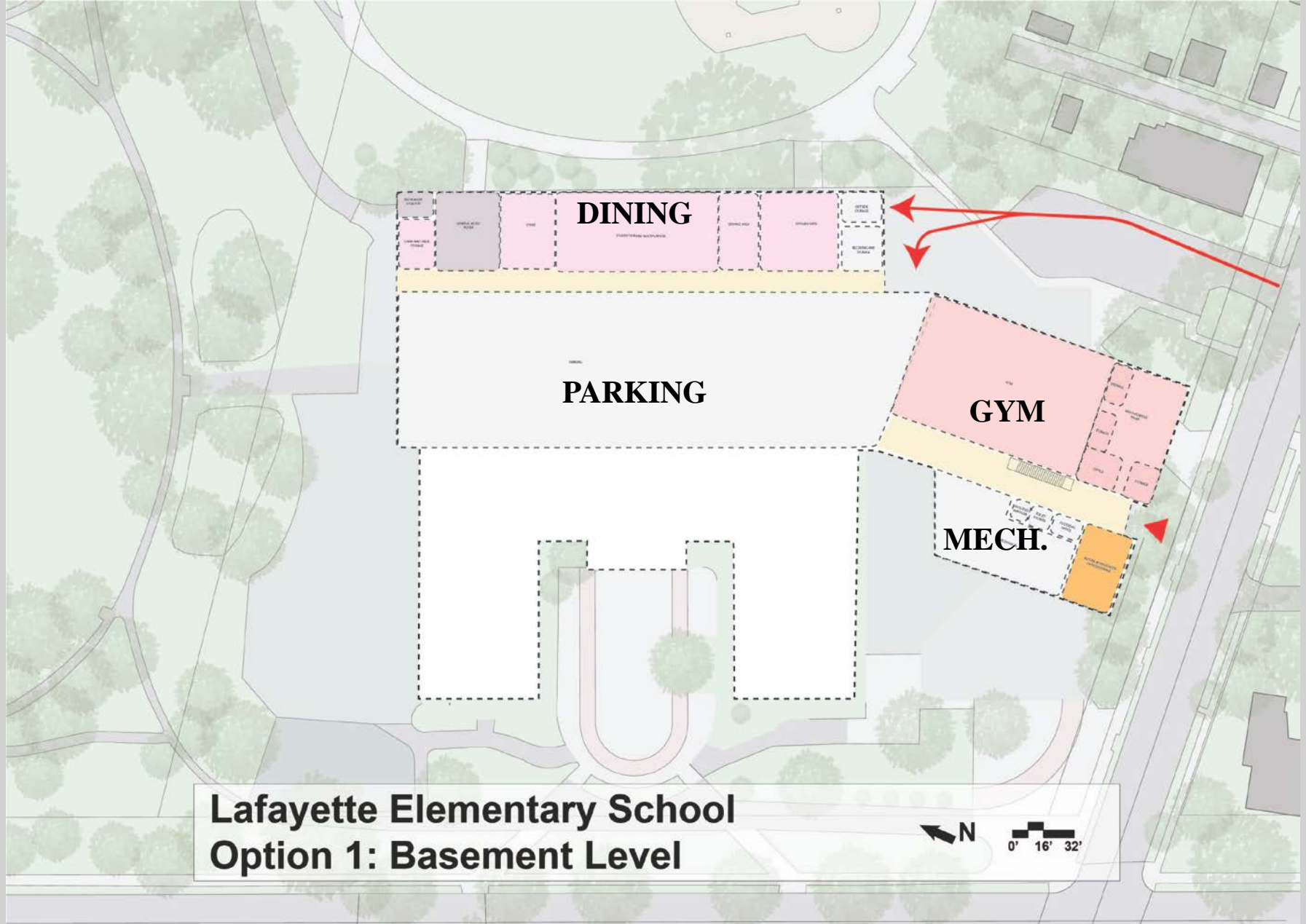

LAFAYETTE ELEMENTARY SCHOOL SIT MEETING – AUGUST 4, 2014



LAFAYETTE ELEMENTARY SCHOOL

HARTMAN-COX ARCHITECTS / GRIMM + PARKER ARCHITECTS
202.333.6446 / 301.595.1000

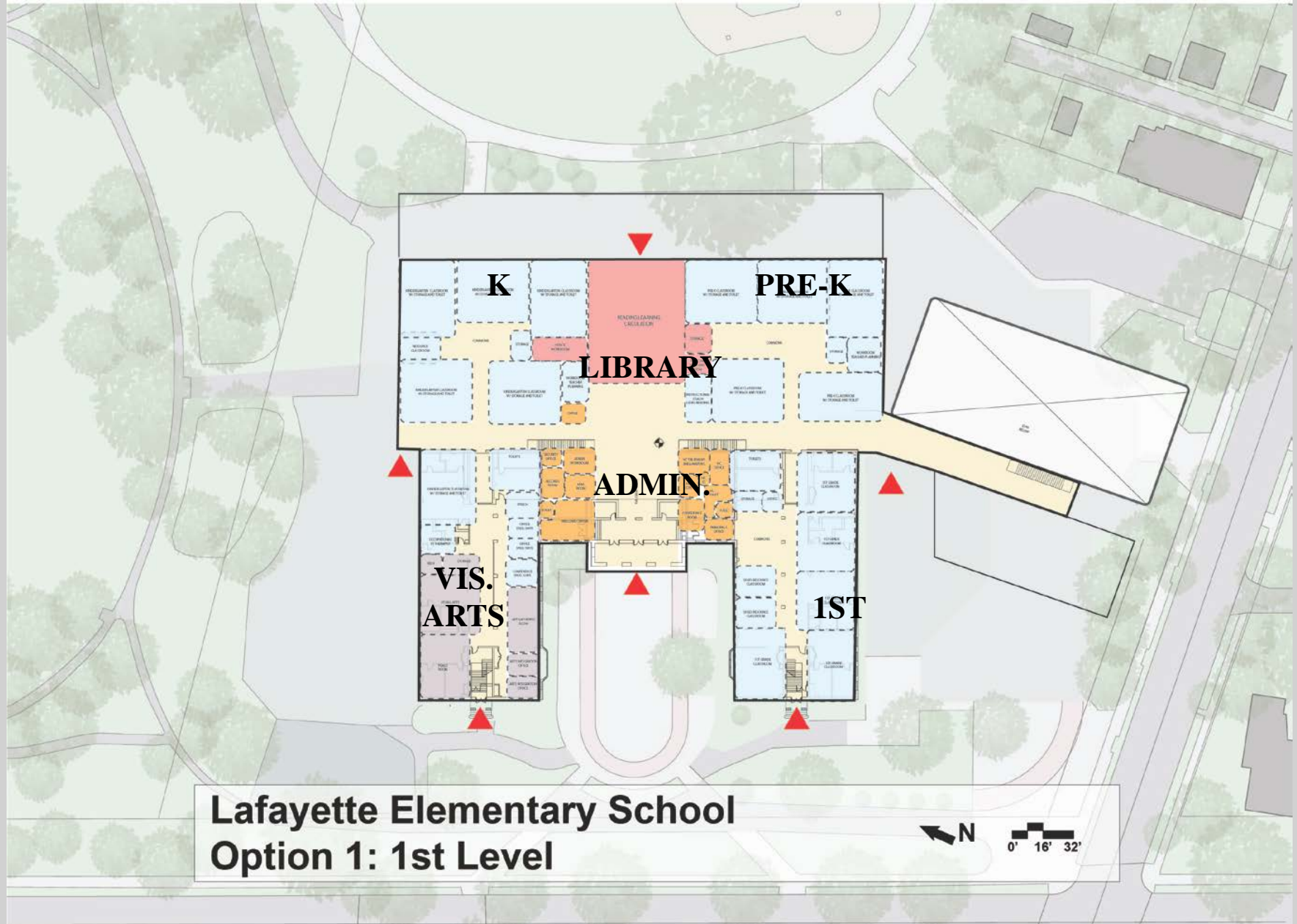

**Lafayette Elementary School
Option 1: 1st Level**

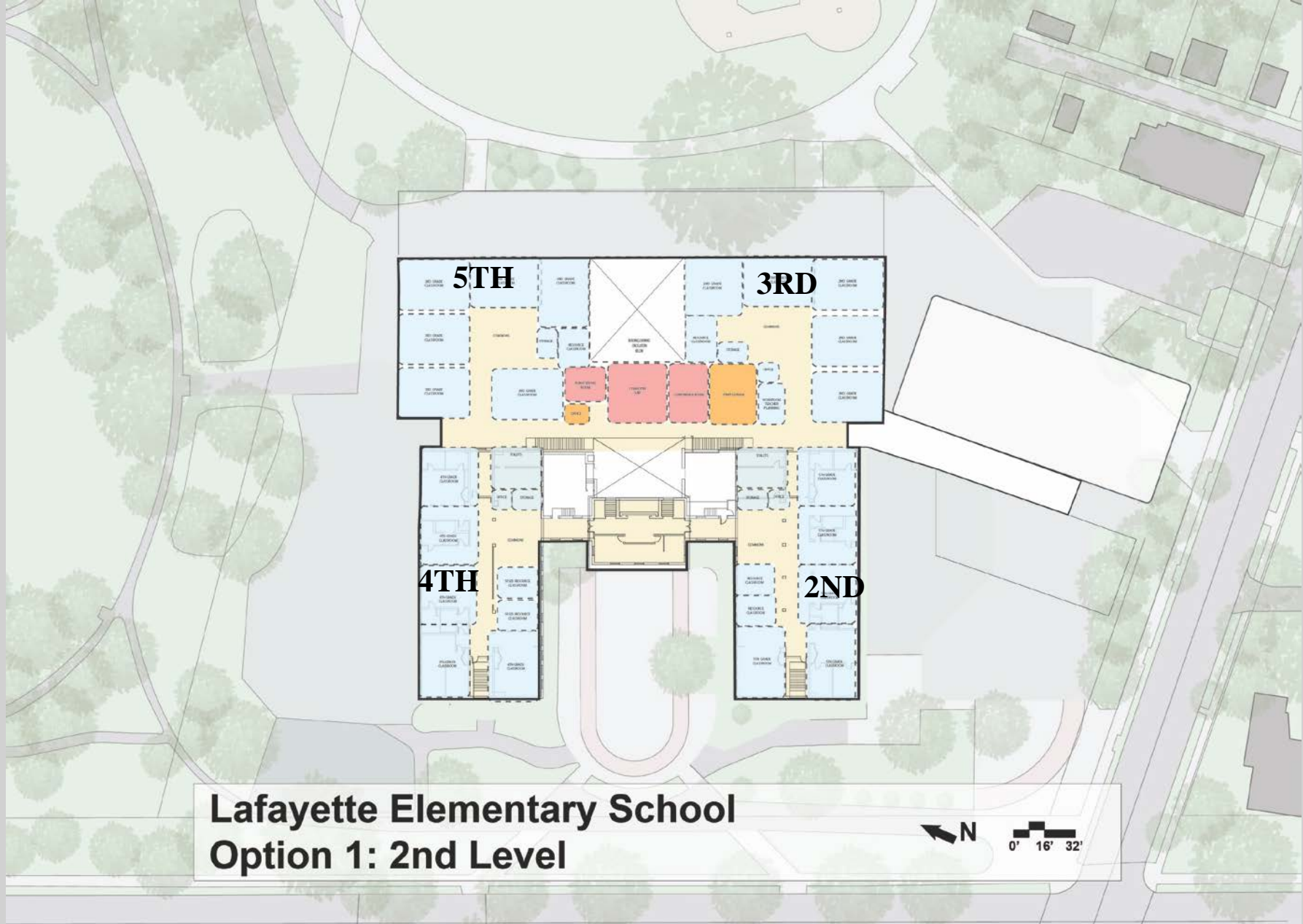

Lafayette Elementary School Option 1: 2nd Level



LAFAYETTE ELEMENTARY SCHOOL SIT MEETING – AUGUST 4, 2014



LAFAYETTE ELEMENTARY SCHOOL

HARTMAN-COX ARCHITECTS / GRIMM + PARKER ARCHITECTS
202.333.6446 / 301.595.1000

Concept-Option 2

LAFAYETTE ELEMENTARY SCHOOL SITE PLAN

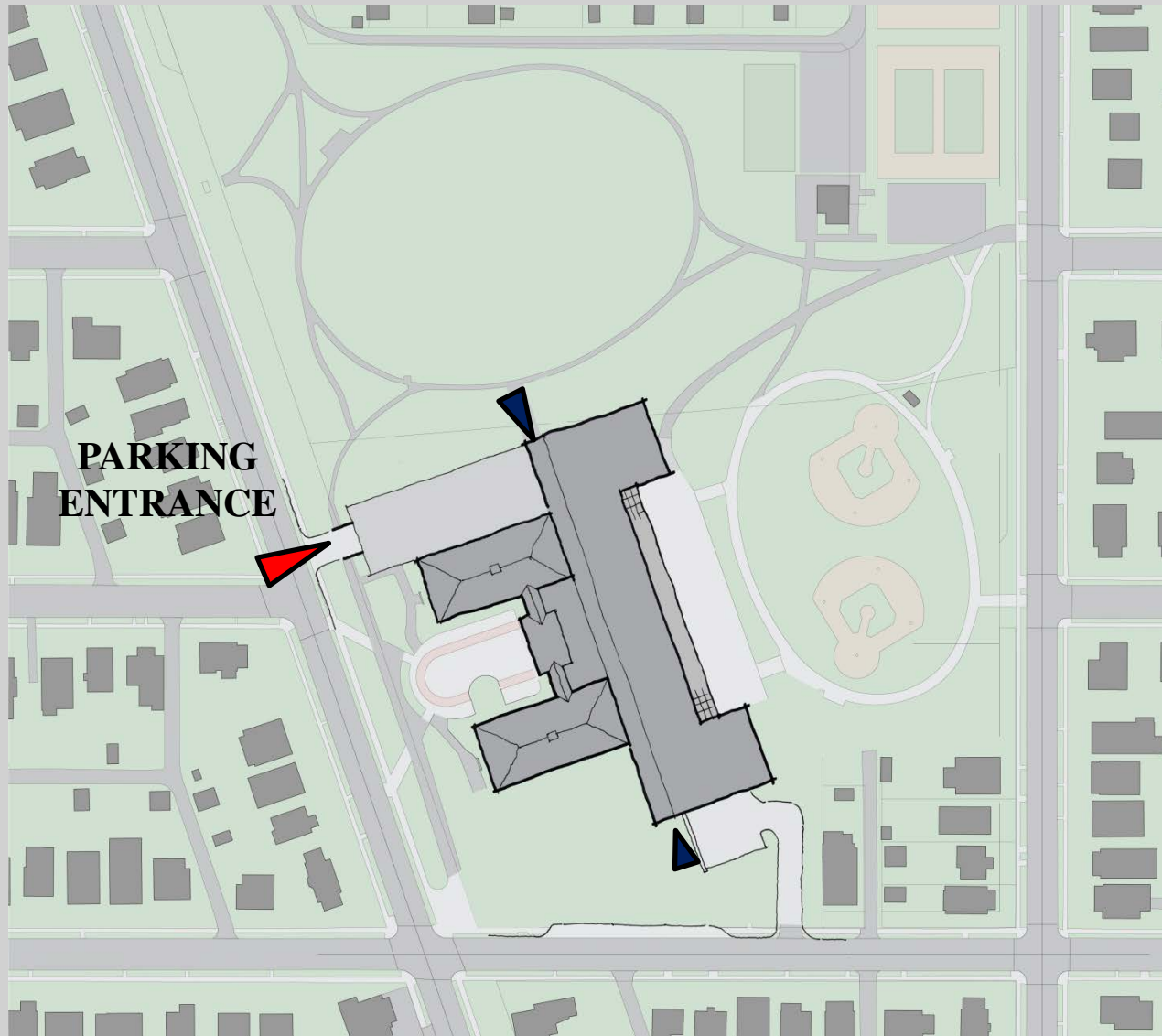

**PARKING
ENTRANCE**

LAFAYETTE ELEMENTARY SCHOOL SIT MEETING – AUGUST 4, 2014



LAFAYETTE ELEMENTARY SCHOOL

HARTMAN-COX ARCHITECTS / GRIMM + PARKER ARCHITECTS
202.333.6446 / 301.595.1000

Option 2-Floor B

LAFAYETTE ELEMENTARY SCHOOL CONCEPT SCHEMES

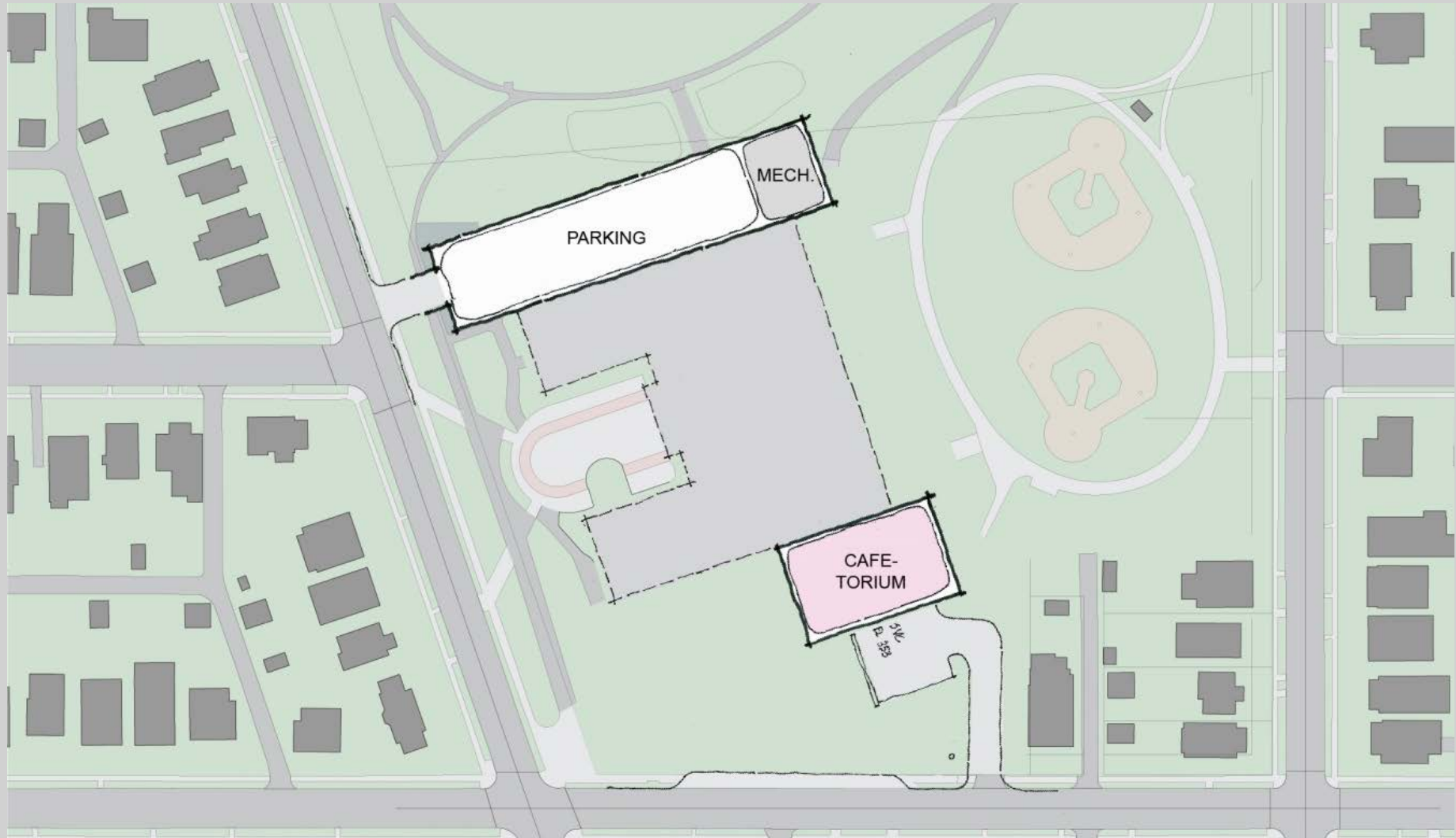

LAFAYETTE ELEMENTARY SCHOOL SIT MEETING – AUGUST 4, 2014



LAFAYETTE ELEMENTARY SCHOOL

HARTMAN-COX ARCHITECTS / GRIMM + PARKER ARCHITECTS
202.333.6446 / 301.595.1000

Option 2-Floor 1

LAFAYETTE ELEMENTARY SCHOOL CONCEPT SCHEMES



LAFAYETTE ELEMENTARY SCHOOL SIT MEETING – AUGUST 4, 2014



LAFAYETTE ELEMENTARY SCHOOL

HARTMAN-COX ARCHITECTS / GRIMM + PARKER ARCHITECTS
202.333.6446 / 301.595.1000

Option 2-Floor 2

LAFAYETTE ELEMENTARY SCHOOL CONCEPT SCHEMES

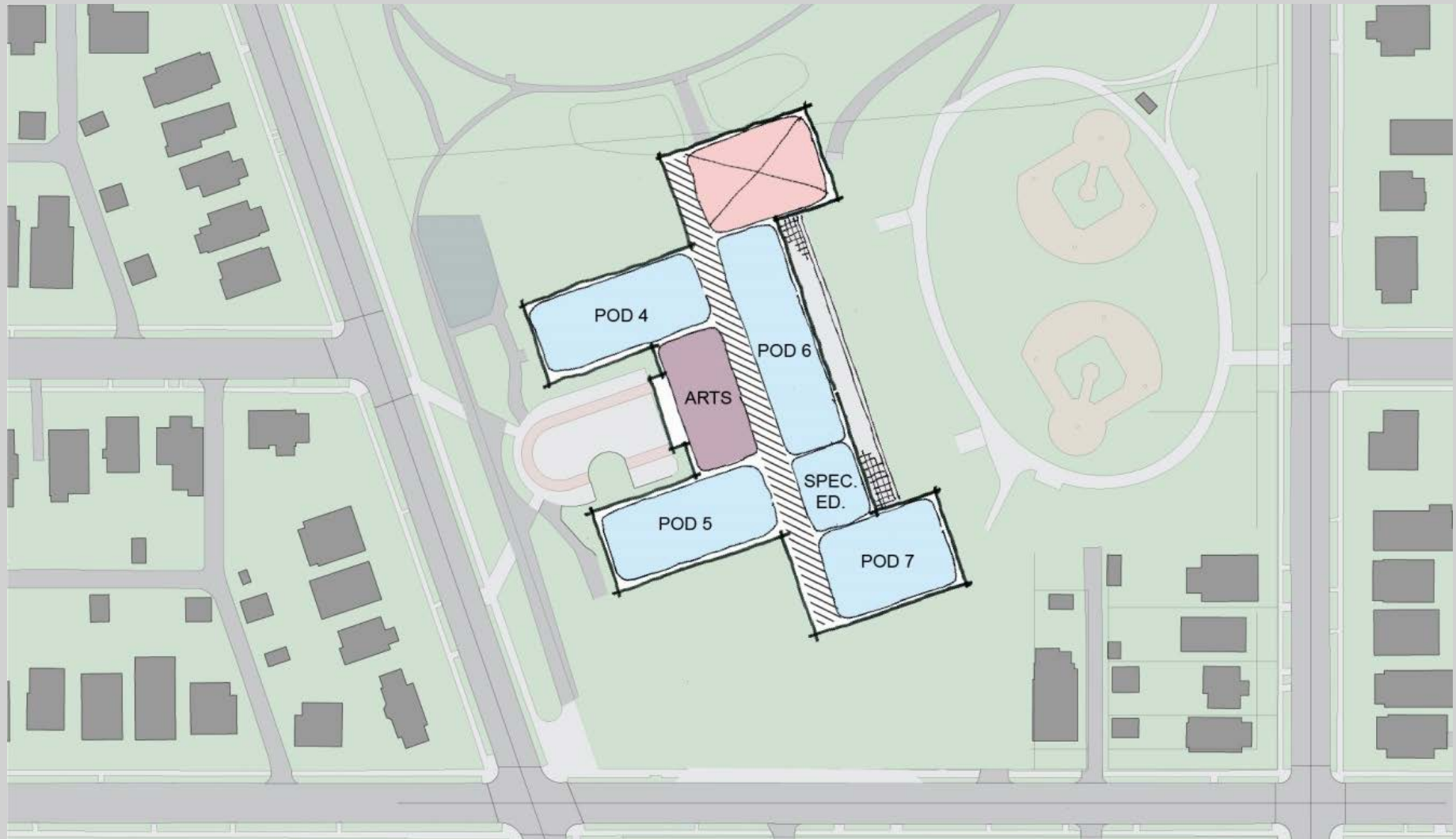

LAFAYETTE ELEMENTARY SCHOOL SIT MEETING – AUGUST 4, 2014



LAFAYETTE ELEMENTARY SCHOOL

HARTMAN-COX ARCHITECTS / GRIMM + PARKER ARCHITECTS
202.333.6446 / 301.595.1000

Concept-Option 3

LAFAYETTE ELEMENTARY SCHOOL SITE PLAN

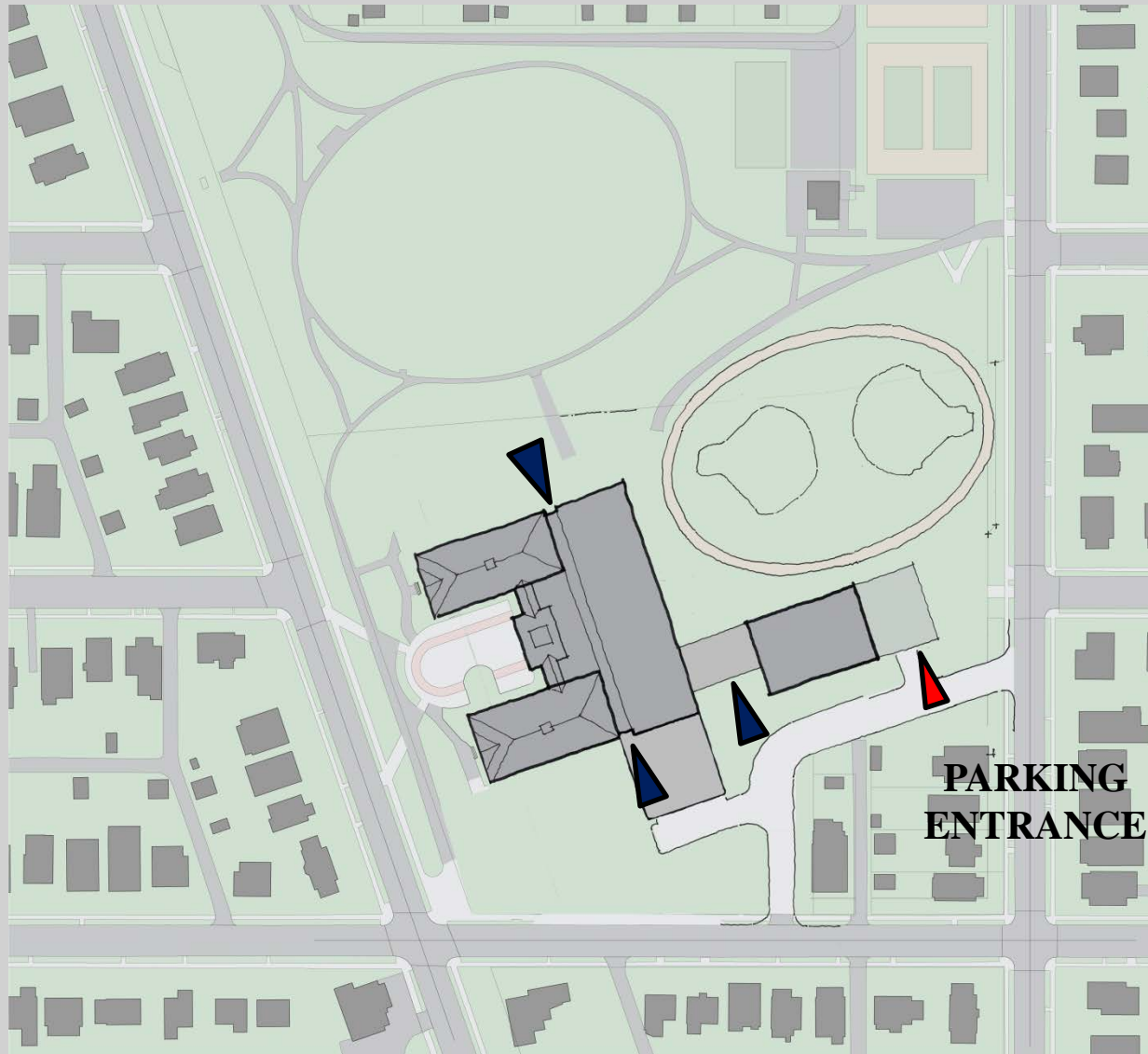

**PARKING
ENTRANCE**

LAFAYETTE ELEMENTARY SCHOOL SIT MEETING – AUGUST 4, 2014



LAFAYETTE ELEMENTARY SCHOOL

HARTMAN-COX ARCHITECTS / GRIMM + PARKER ARCHITECTS
202.333.6446 / 301.595.1000

Option 3-Floor B2

LAFAYETTE ELEMENTARY SCHOOL CONCEPT SCHEMES

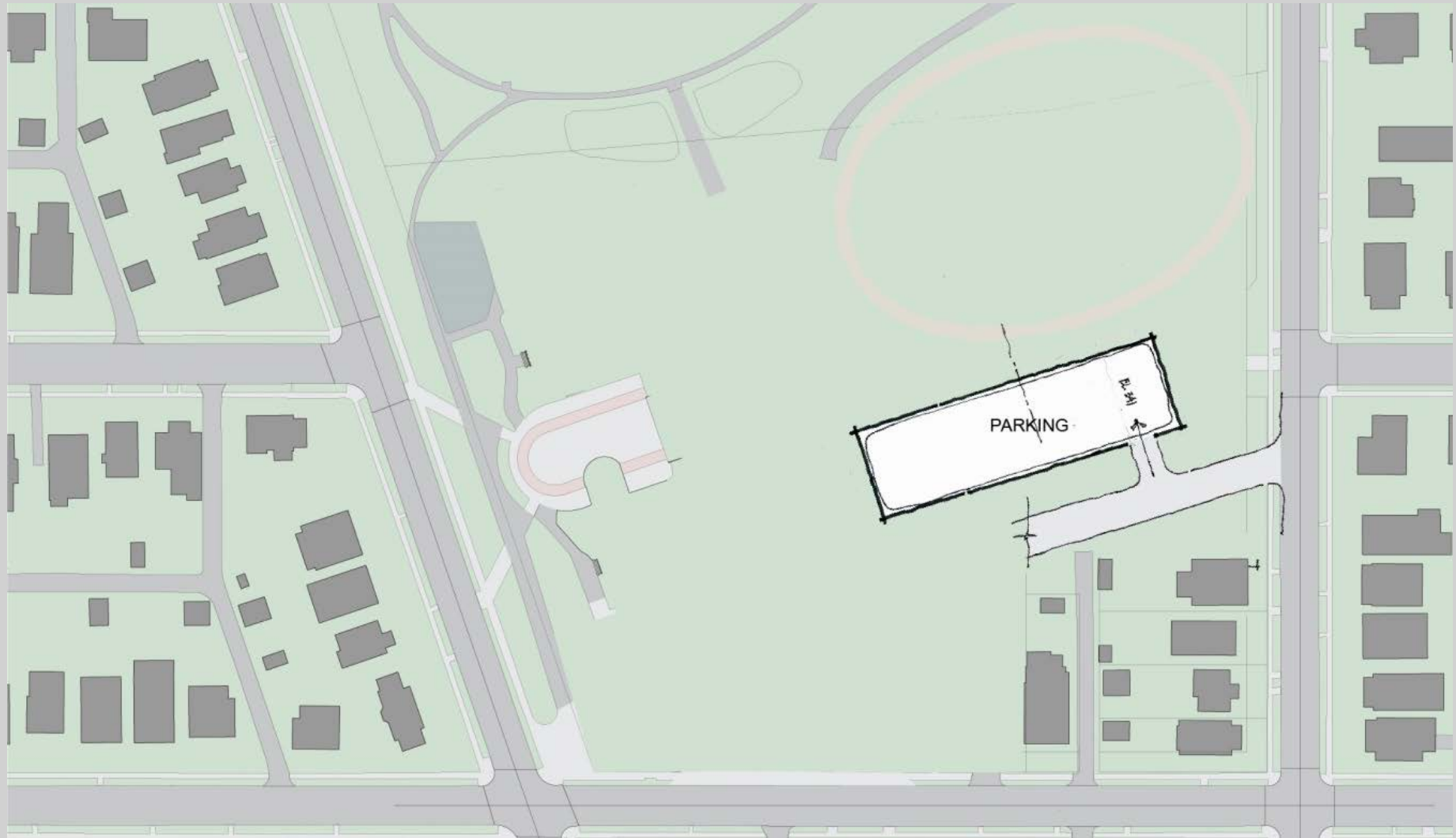

LAFAYETTE ELEMENTARY SCHOOL SIT MEETING – AUGUST 4, 2014



LAFAYETTE ELEMENTARY SCHOOL

HARTMAN-COX ARCHITECTS / GRIMM + PARKER ARCHITECTS
202.333.6446 / 301.595.1000

Option 3-Floor B

LAFAYETTE ELEMENTARY SCHOOL CONCEPT SCHEMES

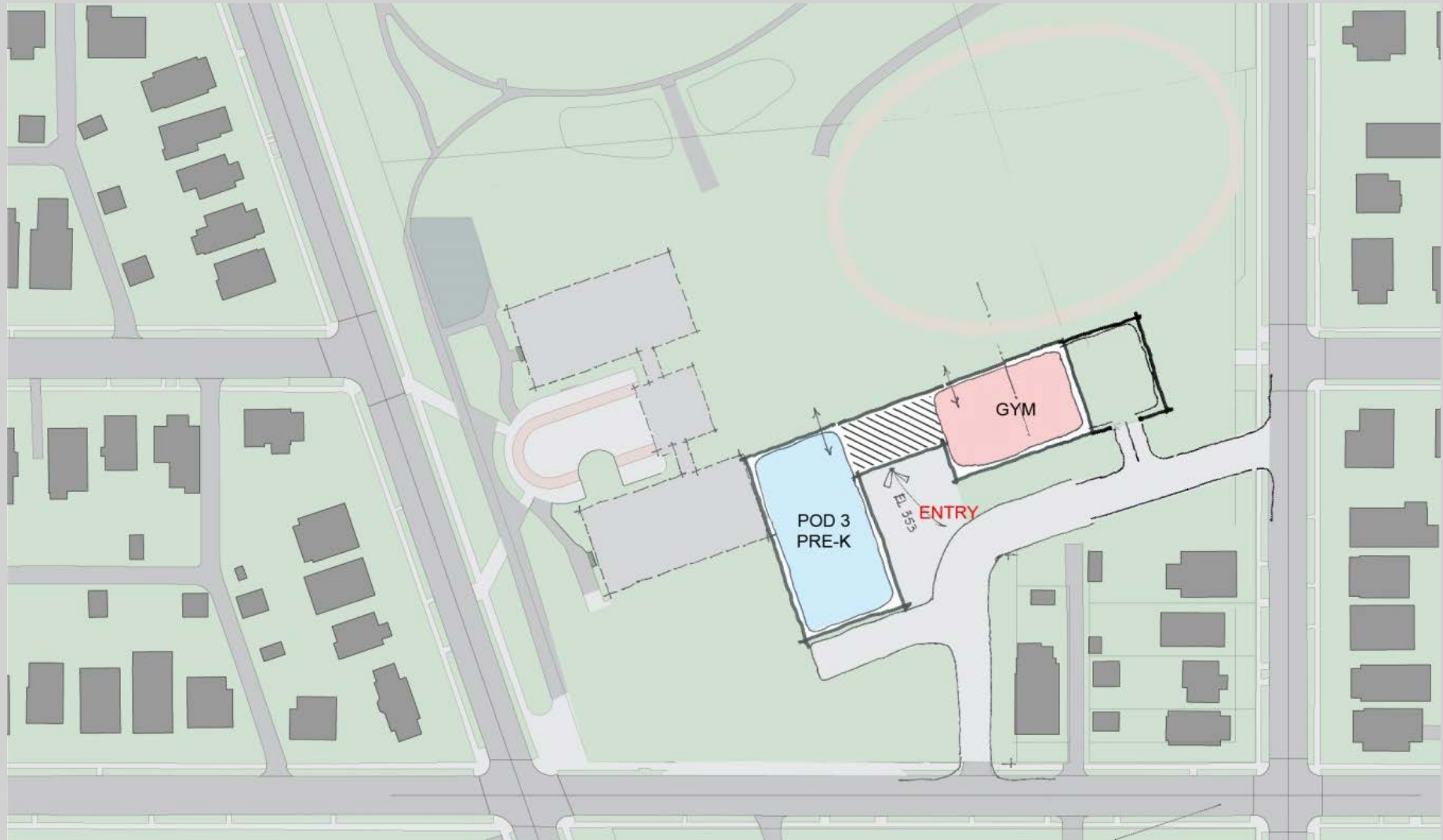

LAFAYETTE ELEMENTARY SCHOOL SIT MEETING – AUGUST 4, 2014



LAFAYETTE ELEMENTARY SCHOOL

HARTMAN-COX ARCHITECTS / GRIMM + PARKER ARCHITECTS
202.333.6446 / 301.595.1000

Option 3-Floor 1

LAFAYETTE ELEMENTARY SCHOOL CONCEPT SCHEMES

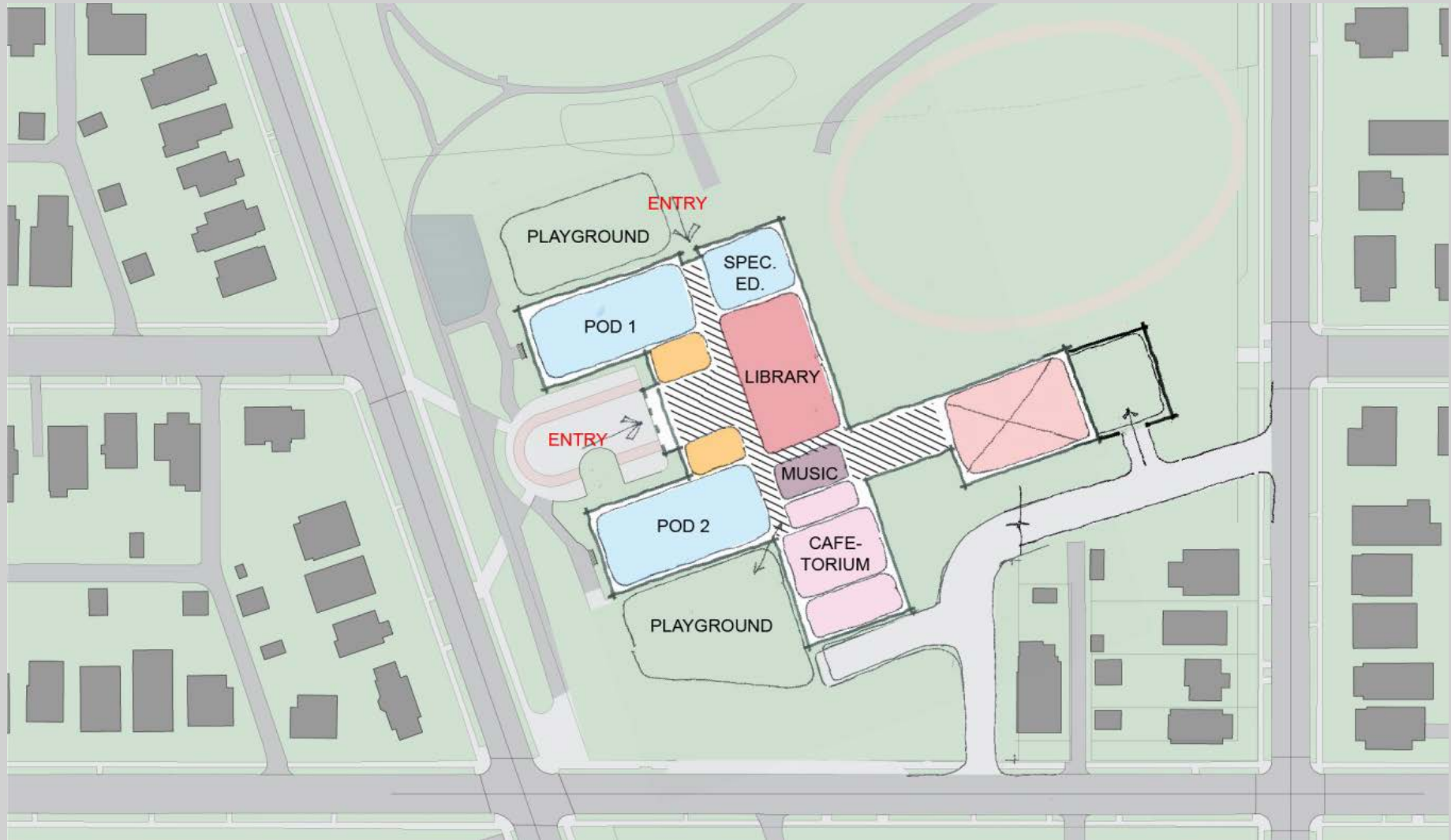

LAFAYETTE ELEMENTARY SCHOOL SIT MEETING – AUGUST 4, 2014



LAFAYETTE ELEMENTARY SCHOOL

HARTMAN-COX ARCHITECTS / GRIMM + PARKER ARCHITECTS
202.333.6446 / 301.595.1000

Option 3-Floor 2

LAFAYETTE ELEMENTARY SCHOOL CONCEPT SCHEMES



LAFAYETTE ELEMENTARY SCHOOL SIT MEETING – AUGUST 4, 2014



LAFAYETTE ELEMENTARY SCHOOL

HARTMAN-COX ARCHITECTS / GRIMM + PARKER ARCHITECTS
202.333.6446 / 301.595.1000



EXTERIOR PRECEDENTS

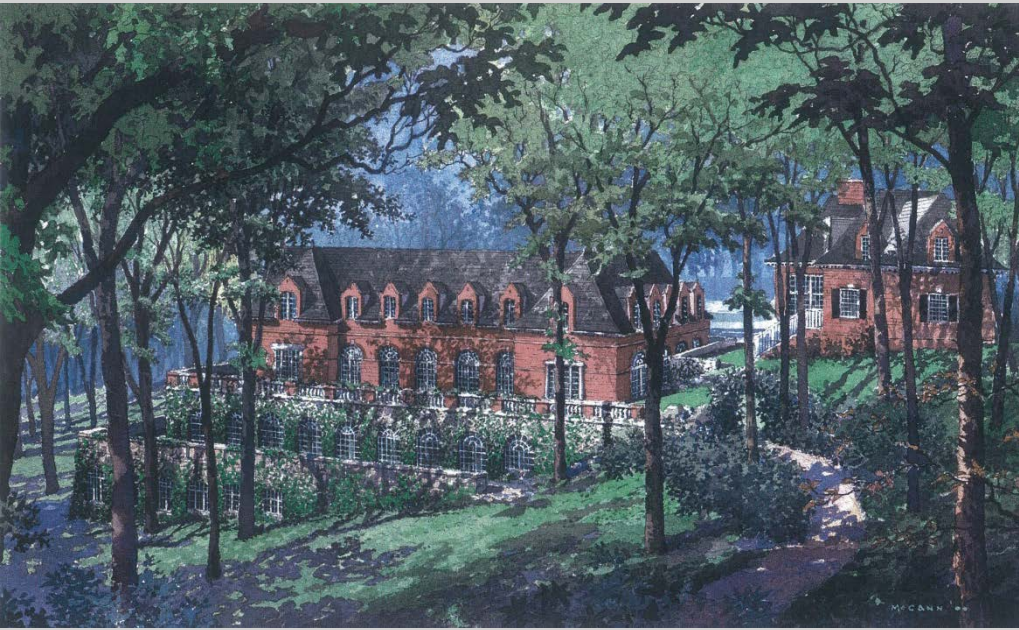

LAFAYETTE ELEMENTARY SCHOOL SIT MEETING – AUGUST 4, 2014



LAFAYETTE ELEMENTARY SCHOOL

HARTMAN-COX ARCHITECTS / GRIMM + PARKER ARCHITECTS
202.333.6446 / 301.595.1000

EXTERIOR PRECEDENTS



LAFAYETTE ELEMENTARY SCHOOL SIT MEETING – AUGUST 4, 2014



LAFAYETTE ELEMENTARY SCHOOL

HARTMAN-COX ARCHITECTS / GRIMM + PARKER ARCHITECTS
202.333.6446 / 301.595.1000

EXTERIOR PRECEDENTS



LAFAYETTE ELEMENTARY SCHOOL SIT MEETING – AUGUST 4, 2014



LAFAYETTE ELEMENTARY SCHOOL

HARTMAN-COX ARCHITECTS / GRIMM + PARKER ARCHITECTS
202.333.6446 / 301.595.1000

EXTERIOR PRECEDENTS



LAFAYETTE ELEMENTARY SCHOOL SIT MEETING – AUGUST 4, 2014



LAFAYETTE ELEMENTARY SCHOOL

HARTMAN-COX ARCHITECTS / GRIMM + PARKER ARCHITECTS
202.333.6446 / 301.595.1000

AGENDA - SIT MEETING #4

- | | | |
|-------------------------------------|------------|------------|
| • Introductions | 10 minutes | 6:00-6:10 |
| • July 12 th SIT Meeting | 20 minutes | 6:10-6:30 |
| • Site Analysis | 30 minutes | 6:30-7:00 |
| • Concept Schemes | 60 minutes | 7:00-8:00 |
| • Exterior Precedents | 15 minutes | 8:00-8:15 |
| • Swing Space | 15 minutes | 8:15-8:30 |
| • Wrap-up | 10 minutes | 8:30- 9:00 |



Swing Space

LAFAYETTE ELEMENTARY SCHOOL OPTION 1 – FULL SWING

- Exist. trailers
- New trailers
- Contractor staging area
- Construction limit
- Temp. circulation structure

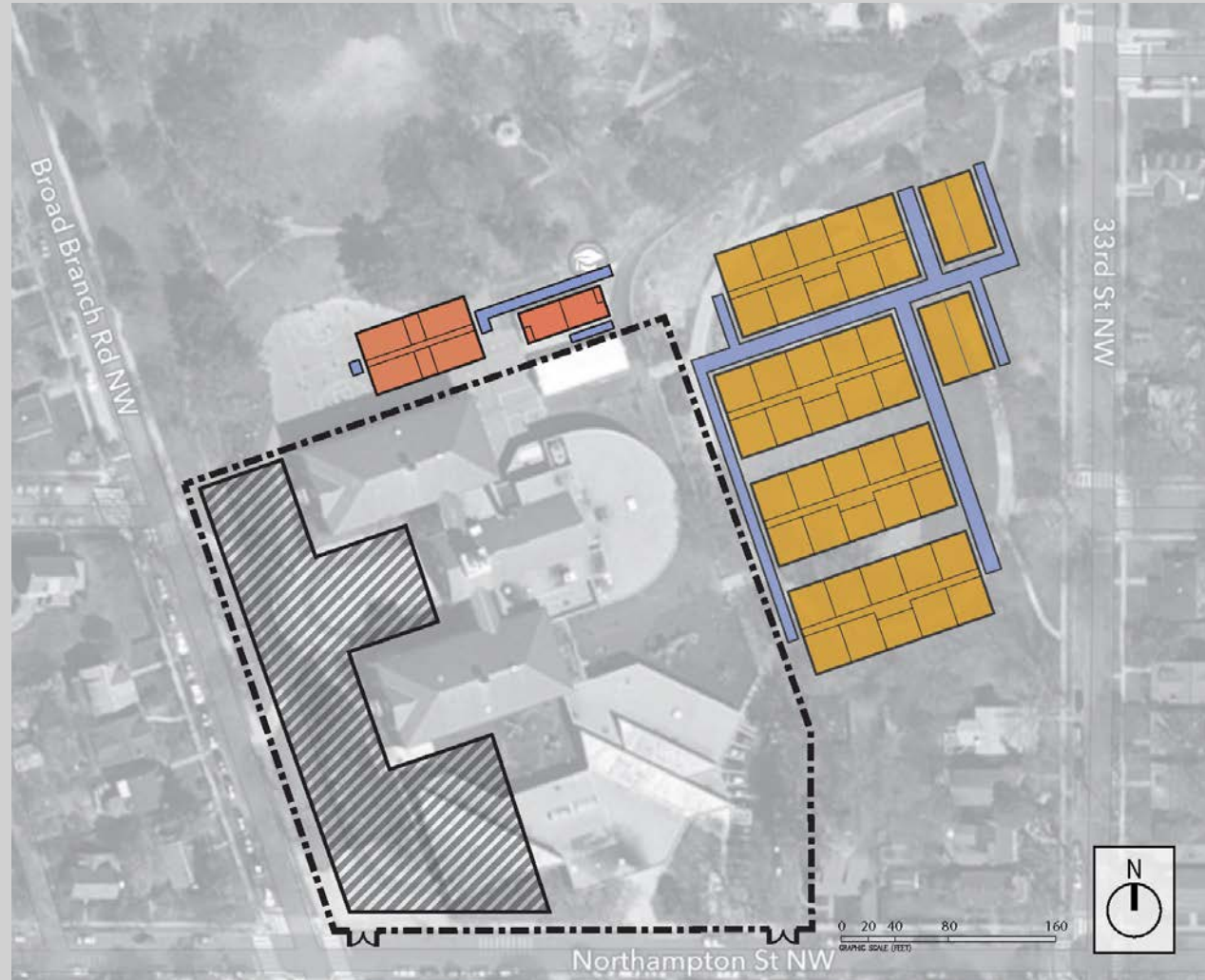

LAFAYETTE ELEMENTARY SCHOOL SIT MEETING – AUGUST 4, 2014



LAFAYETTE ELEMENTARY SCHOOL

HARTMAN-COX ARCHITECTS / GRIMM + PARKER ARCHITECTS
202.333.6446 / 301.595.1000

Swing Space

LAFAYETTE ELEMENTARY SCHOOL OPTION 2 – PARTIAL SWING WITH GYM

- Swing space in exist. bldg.
- Exist. trailers
- New trailers
- Contractor staging area
- Construction limit
- Temp. circulation structure
- Long-span temp. structure

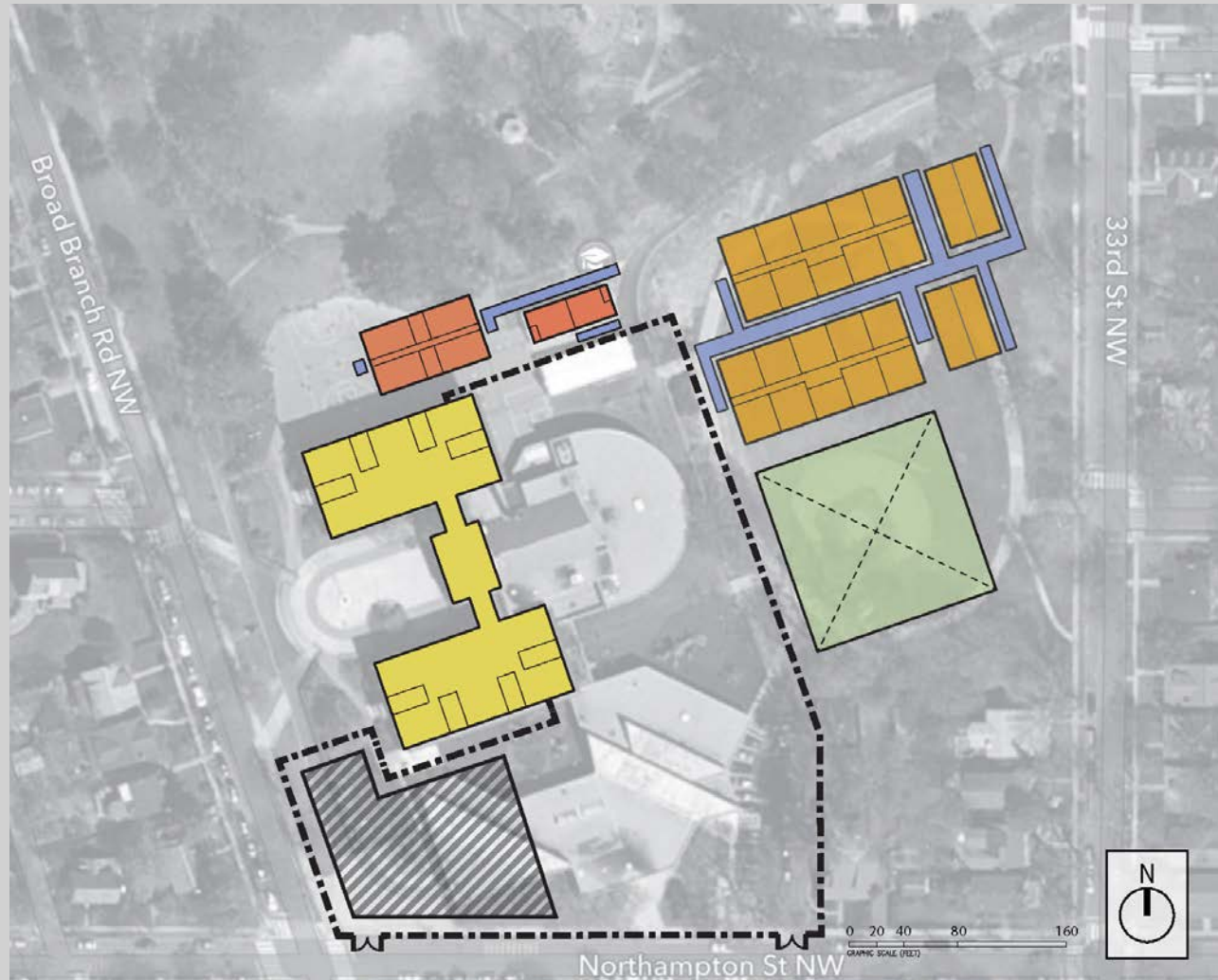

LAFAYETTE ELEMENTARY SCHOOL SIT MEETING – AUGUST 4, 2014



LAFAYETTE ELEMENTARY SCHOOL

HARTMAN-COX ARCHITECTS / GRIMM + PARKER ARCHITECTS
202.333.6446 / 301.595.1000

Swing Space

LAFAYETTE ELEMENTARY SCHOOL OPTION 3 – PARTIAL SWING WITHOUT GYM

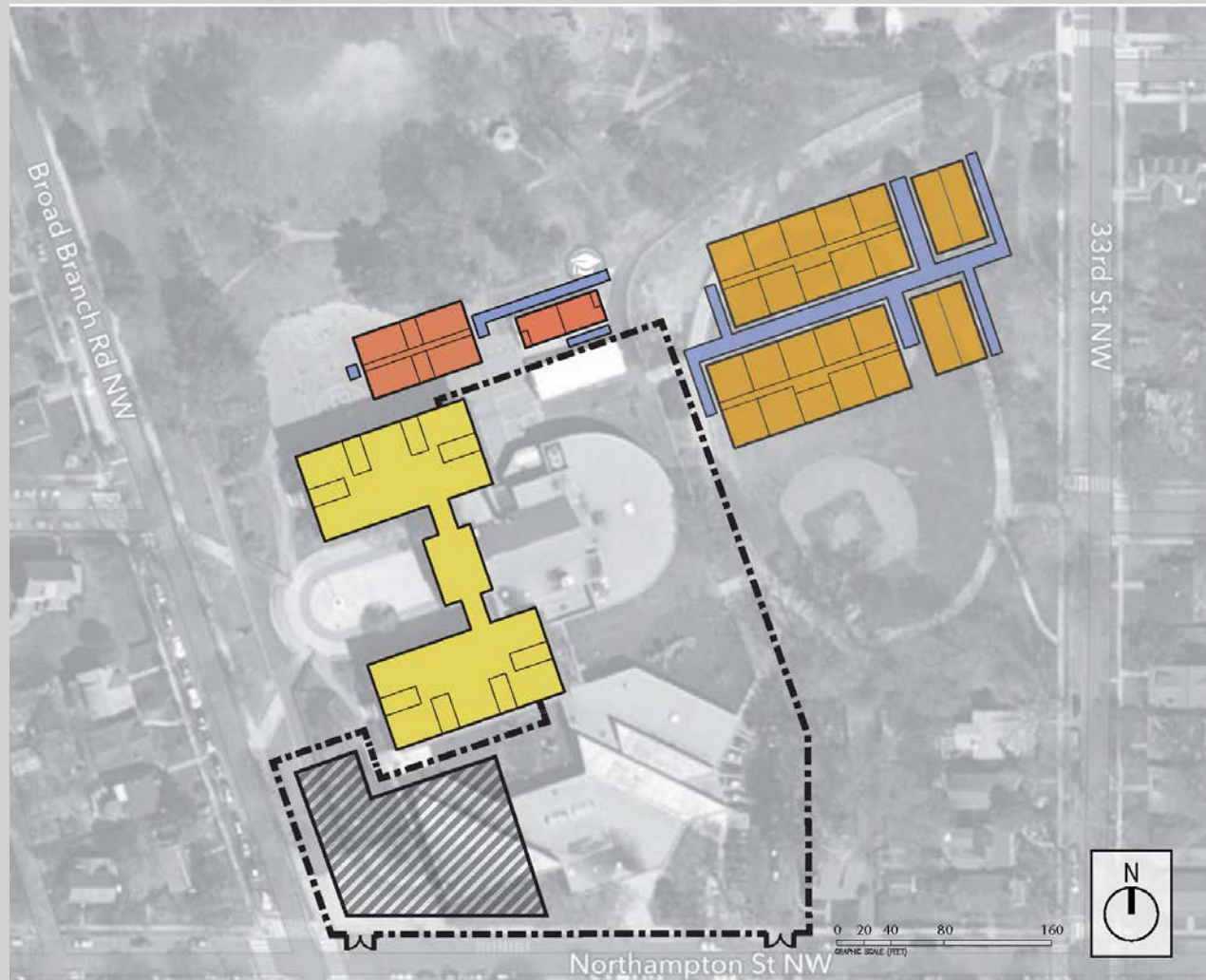
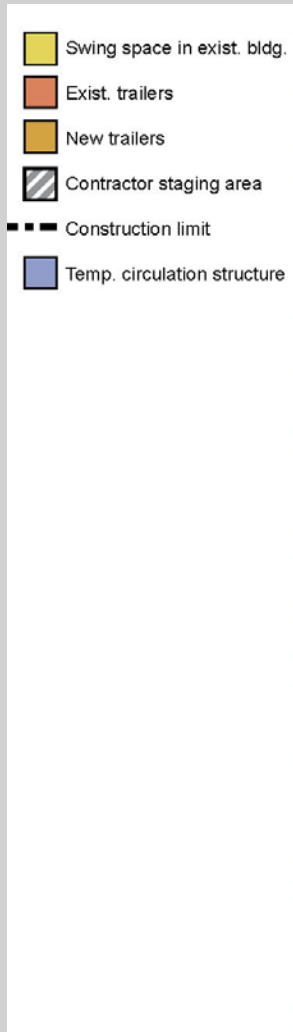

LAFAYETTE ELEMENTARY SCHOOL SIT MEETING – AUGUST 4, 2014



LAFAYETTE ELEMENTARY SCHOOL

HARTMAN-COX ARCHITECTS / GRIMM + PARKER ARCHITECTS
202.333.6446 / 301.595.1000

AGENDA - SIT MEETING #4

- | | | |
|-------------------------------------|------------|------------|
| • Introductions | 10 minutes | 6:00-6:10 |
| • July 12 th SIT Meeting | 20 minutes | 6:10-6:30 |
| • Site Analysis | 30 minutes | 6:30-7:00 |
| • Concept Schemes | 60 minutes | 7:00-8:00 |
| • Exterior Precedents | 15 minutes | 8:00-8:15 |
| • Swing Space | 15 minutes | 8:15-8:30 |
| • Wrap-up | 10 minutes | 8:30- 9:00 |

